

APPROVED BY RESOLUTION OF THE PLANNING BOARD OF THE CITY OF BEACON, NEW YORK, ON THE \_\_\_\_\_ DAY OF \_\_\_\_\_ 20\_\_\_\_ SUBJECT TO ALL REQUIREMENTS AND CONDITIONS OF SAID RESOLUTION. ANY CHANGE, ERASURE, MODIFICATION OR REVISION OF THIS PLAN, AS APPROVED, SHALL VOID THIS APPROVAL.

SIGNED THIS \_\_\_\_\_ DAY OF \_\_\_\_\_ 20\_\_\_\_ BY \_\_\_\_\_ CHAIRMAN \_\_\_\_\_ SECRETARY

IN ABSENCE OF THE CHAIRMAN OR SECRETARY, THE ACTING CHAIRMAN OR ACTING SECRETARY RESPECTIVELY MAY SIGN IN THIS PLACE.

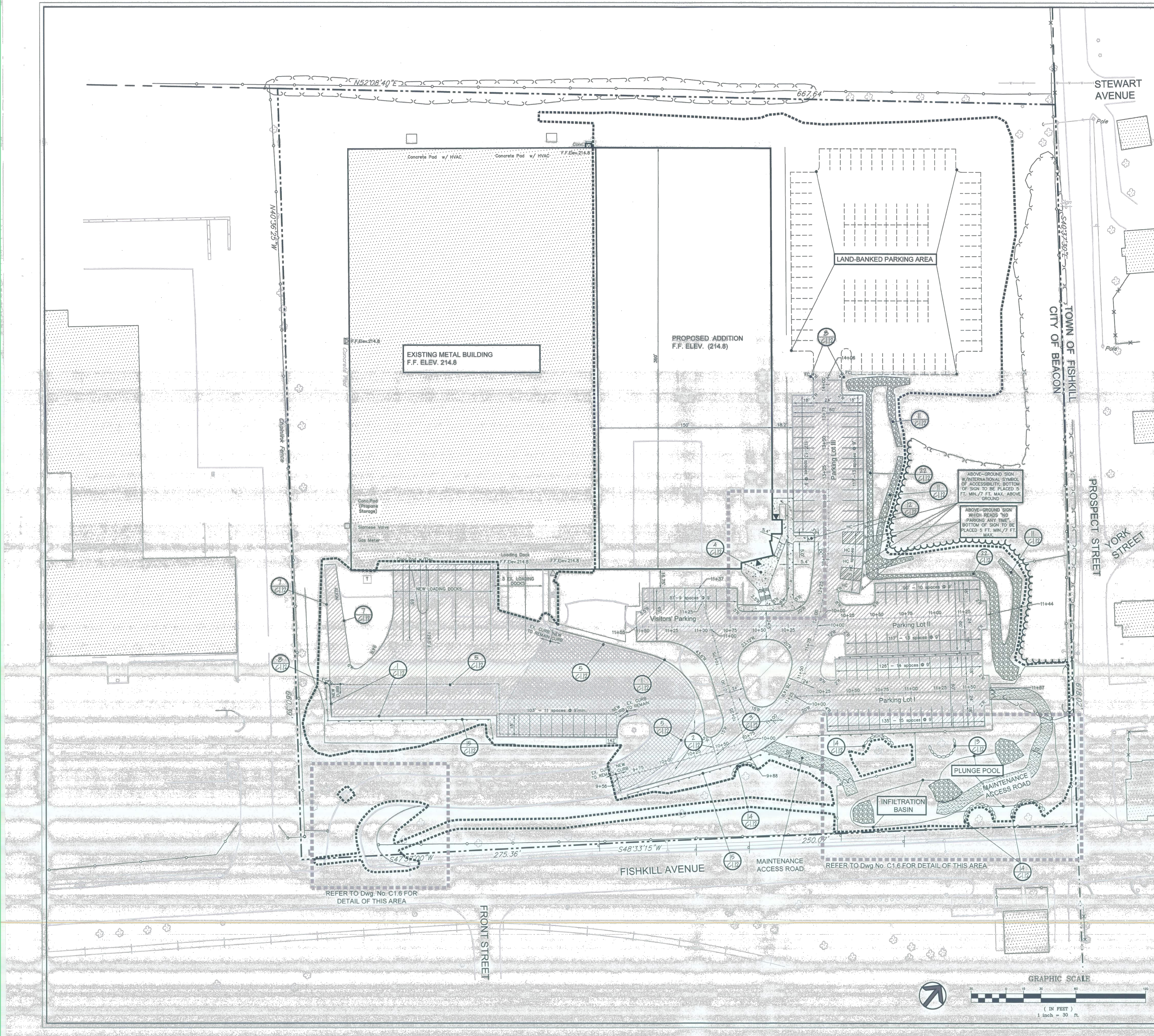

**LEGEND (Dwg. No. C1.3)**

DESCRIPTION	EXISTING	PROPOSED
PROPERTY LINE	[Symbol]	N/A
BUILDING	[Symbol]	[Symbol]
DISTURBANCE LIMIT LINE	N/A	[Symbol]
WELL	[Symbol]	N/A
MONITORING WELL	[Symbol]	N/A
TRANSFORMER	[Symbol]	N/A
TREE	[Symbol]	REFER TO DWG. NO. C1.13
TREE WALL/WELL	N/A	[Symbol]
TREE LINE	[Symbol]	[Symbol]
CONCRETE CURB	[Symbol]	[Symbol]
DROP CURB	N/A	[Symbol]
CONCRETE WALK	N/A	[Symbol]
HANDICAPPED RAMP	N/A	[Symbol]
PARKING STALL	N/A	[Symbol]
HC PARKING SYMBOL	N/A	HC
SEP-RAP SWALE	N/A	[Symbol]
NEW PAVEMENT	N/A	[Symbol]
PAVEMENT OVERLAY	N/A	[Symbol]
PAVEMENT RAISE	N/A	[Symbol]
LIGHT POLE	[Symbol]	REFER TO DWG. C1.14
PAVEMENT NOTCHING INTO EXISTING PAVEMENT	N/A	[Symbol]
GUIDE RAIL	N/A	[Symbol]
PAVEMENT EDGE	[Symbol]	[Symbol]
SIGN	[Symbol]	N/A
FENCE	[Symbol]	[Symbol]
BUILDING ENTRANCE	[Symbol]	[Symbol]
MAINTENANCE ACCESS ROAD	N/A	[Symbol]

**MECHTRONICS CORPORATION**  
 511 Fishkill Avenue  
 City of Beacon  
 New York, 12508

**KG&D architects**  
 Keyser, Garment & Davidson architects, pc  
 285 main street mount kisco, new york 10549  
 p:914.666.9900 f:914.666.0053 kgedarchitects.com

**SITE DEVELOPMENT PLAN APPLICATION**

Owner:  
 RICHARD J. FELLINGER  
 1 NEW KING STREET  
 WHITE PLAINS, NY 10604

Applicant:  
 RICHARD J. FELLINGER  
 1 NEW KING STREET  
 WHITE PLAINS, NY 10604

Tax ID:  
 Section 6055  
 BLOCK 4  
 LOT 580 285

APPROVED FOR CONSTRUCTION  
 DEC. 16, 2010  
*David Buckley*  
 BUILDING PROFESSIONAL

REVISIONS:

NO.	DATE	DESCRIPTION	BY
1	07-30-10	PERMIT AND CONSTRUCTION	
2	01-25-10	REVISED PER CITY ENGINEER COMMENT LETTER 01/14/10 AND VISIT 01/25/10	
3	12-15-09	REVISED PER CITY ENGINEER COMMENT LETTER 12/02/09	
4	11-17-09	REVISED PER CITY ENGINEER 10/9/09 AND 11/6/09 VISIT COMMENTS	
5	09-30-09	ISSUED FOR SITE PLAN APPROVAL	
6	06-26-09	SITE PLAN APPLICATION	
7	06-05-09	SITE PLAN APPLICATION	
8	03-31-09	CONCEPTUAL SITE PLAN APP.	

**LAYOUT and PAVEMENT PLAN**

**C1.2**

Job No.: 2009-1013  
 Date: 10/06/09  
 Scale: AS NOTED  
 Drawn/Checked: SL/SL

**Site Plan**  
 Scale: 1" = 30'

**Amendment to Site Plan Application**  
 Previously Approved Site Plan For Reference Only - Sheet 3 of 13