

SURVEY NOTES:

- SEE SHEET 1 FOR METES AND BOUNDS FOR EXISTING AND PROPOSED PROPERTY LINES.

EROSION AND SEDIMENT CONTROL NOTES:

- ALL EROSION CONTROL MEASURES EMPLOYED DURING THE CONSTRUCTION PROCESS SHALL BE INSPECTED BY THE CONTRACTOR IN ACCORDANCE WITH THE MAINTENANCE SCHEDULE. ALL EROSION CONTROL STRUCTURES SHALL BE REPAIRED AND MAINTAINED AS NECESSARY BY THE CONTRACTOR.
- ALL STORMWATER MANAGEMENT STRUCTURES (E.G. CATCH BASINS) SHALL BE REGULARLY INSPECTED FOR SEDIMENT ACCUMULATIONS. CATCH BASINS SHALL BE CLEANED WHEN SEDIMENT DEPTH REACHES A MAXIMUM OF ONE-HALF THE AVAILABLE SUMP DEPTH.
- ALL EROSION CONTROL INSTALLATION AND MAINTENANCE MEASURES SHALL MEET THE REQUIREMENTS OF THE NEW YORK STANDARDS AND SPECIFICATIONS FOR EROSION AND SEDIMENT CONTROL.
- ANY PILE OF POTENTIALLY ERODIVE MATERIAL TEMPORARILY STOCKPILED ON THE SITE DURING THE CONSTRUCTION PROCESS SHALL BE LOCATED IN AN AREA AWAY FROM STORM DRAINAGE AND SHALL BE PROPERLY PROTECTED FROM EROSION BY A SURROUNDING SILT FENCE.
- PERMANENT SEEDED AREAS FOR EROSION CONTROL SHALL BE IN ACCORDANCE WITH DETAIL AND SPECIFICATIONS ON THIS SHEET.
- AREAS UNDERGOING CLEARING OR GRADING AND WHERE WORK IS DELAYED OR COMPLETED AND WILL NOT BE REDISTURBED FOR A PERIOD OF 21 DAYS OR MORE SHALL BE STABILIZED WITH TEMPORARY OR PERMANENT VEGETATIVE COVER WITHIN 14 DAYS.
- ON-SITE DUST CONTROL SHALL BE ACCOMPLISHED BY STANDARD METHODS OF LIGHTLY WATERING ALL EXPOSED SOIL AND RAPIDLY STABILIZING THE REGRADED AREAS WITH TOPSOIL, LOAM AND/OR SEEDING.
- THE CITY ENGINEER AND PROJECT ENGINEER SHALL BE NOTIFIED NO LESS THAN 48 HOURS PRIOR TO THE START OF ANY SITE WORK, AND BY SUCH NOTIFICATION, SHALL BE PROVIDED WITH THE NAME AND TELEPHONE NUMBER OF THE GENERAL CONTRACTOR RESPONSIBLE FOR SUCH WORK.
- THE CITY AND/OR ITS REPRESENTATIVES MAY INSPECT EROSION AND SEDIMENT CONTROL PRACTICES ON THE SITE DURING CONSTRUCTION AND RECOMMEND THAT THE CONTRACTOR INSTALL ADDITIONAL EROSION CONTROL MEASURES IF DEEMED NECESSARY TO PROTECT ANY UNDISTURBED AREAS OF THE SITE. ANY SUCH REQUESTS SHALL BE MADE DIRECTLY TO THE CONTRACTOR AND QUALIFIED PROFESSIONAL AND FOLLOWED UP WITH A WRITTEN NOTIFICATION TO THE DEVELOPER. IN ADDITION, THE PROJECT ENGINEER SHALL BE CONSULTED ON ANY SPECIAL ADDITIONS OR DELETIONS OF EROSION CONTROL MEASURES WARRANTED BY CHANGING FIELD CONDITIONS.
- IF GROUNDWATER IS ENCOUNTERED DURING CONSTRUCTION ACTIVITIES, THE CONTRACTOR SHALL CONSTRUCT A DEWATERING PIT IN ACCORDANCE WITH NEW YORK STANDARDS AND SPECIFICATIONS FOR EROSION AND SEDIMENT CONTROL TO FILTER WATER FOR PUMPING TO A SUITABLE LOCATION.
- WHEN ALL DISTURBED AREAS ARE STABLE, ALL TEMPORARY EROSION AND SEDIMENT CONTROL MEASURES SHALL BE REMOVED.
- STORMWATER SUMPS SHALL BE PROPERLY MAINTAINED BY WEEDING AND TRIMMING THE DROUGHT TOLERANT SPECIES TWICE A YEAR. MULCH SHALL BE REPLACED WHEN SEDIMENT BUILDUP OBSERVED AND THE INFILTRATIVE CAPACITY OF THE SUMP IS DIMINISHED.
- STORMWATER SUMP OVERFLOW WEIR SHALL BE INSPECTED ANNUALLY, OR AFTER ANY LARGE STORM EVENTS. SEDIMENT ACCUMULATION SHALL BE MONITORED AND REMOVED FROM RIP RAP AS REQUIRED. DEBRIS SHALL BE REMOVED WHEN BUILD-UP HAS ACCUMULATED TO APPROXIMATELY 10% TO 20% OF WEIR CAPACITY.

OWNER'S CONSENT:

THE UNDERSIGNED OWNER OF THE PROPERTY HEREON STATES THAT HE IS FAMILIAR WITH THIS MAP, ITS CONTENTS AND ITS LEGENDS AND HEREBY CONSENTS TO ALL SAID TERMS AND CONDITIONS AS STATED HEREON.

RINA SHUMAN

DATE

OWNER'S CONSENT:

THE UNDERSIGNED OWNER OF THE PROPERTY HEREON STATES THAT HE IS FAMILIAR WITH THIS MAP, ITS CONTENTS AND ITS LEGENDS AND HEREBY CONSENTS TO ALL SAID TERMS AND CONDITIONS AS STATED HEREON.

GARY JOSEPH

DATE

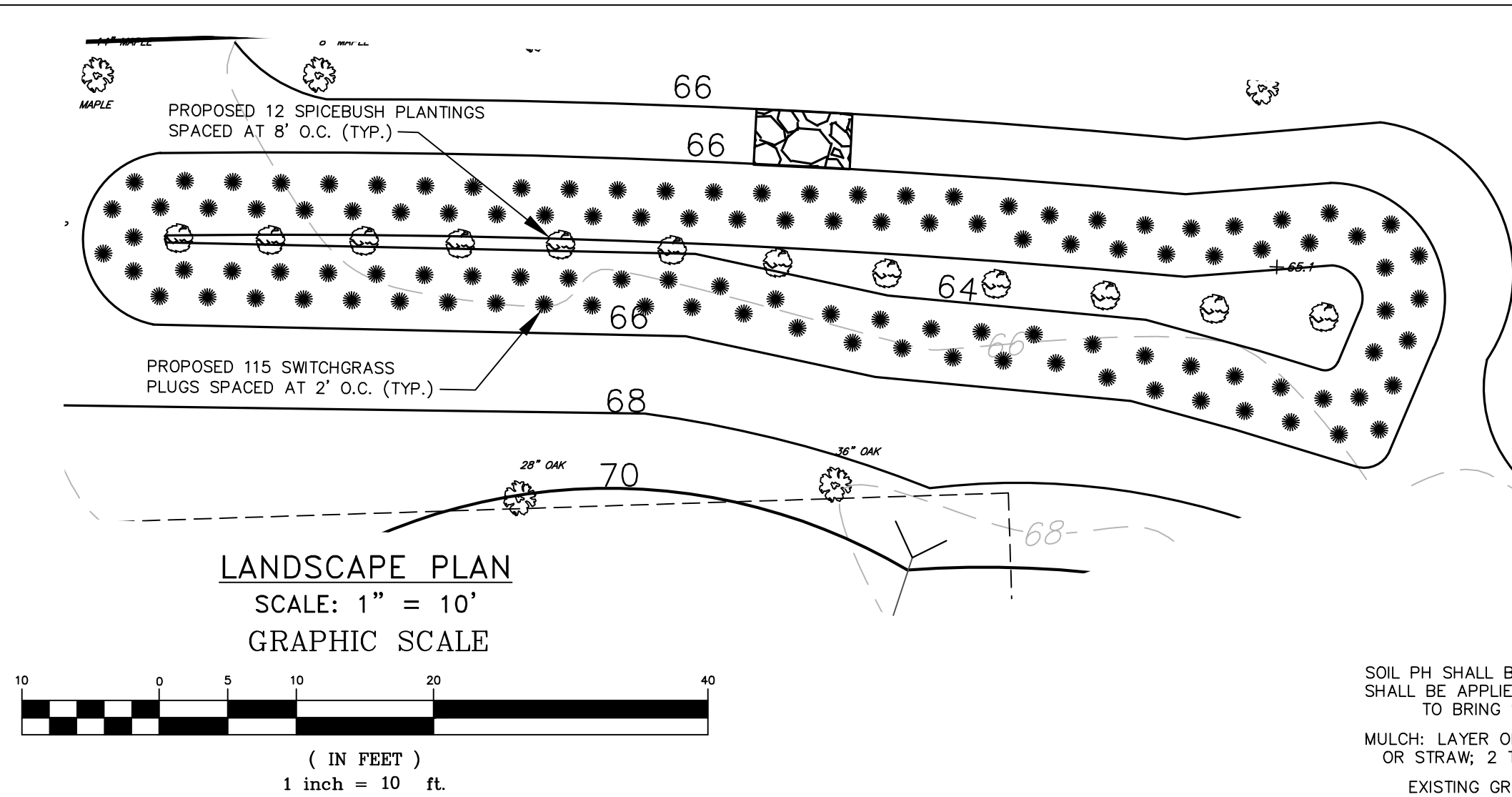

LANDSCAPE PLAN SCALE: 1" = 10' GRAPHIC SCALE

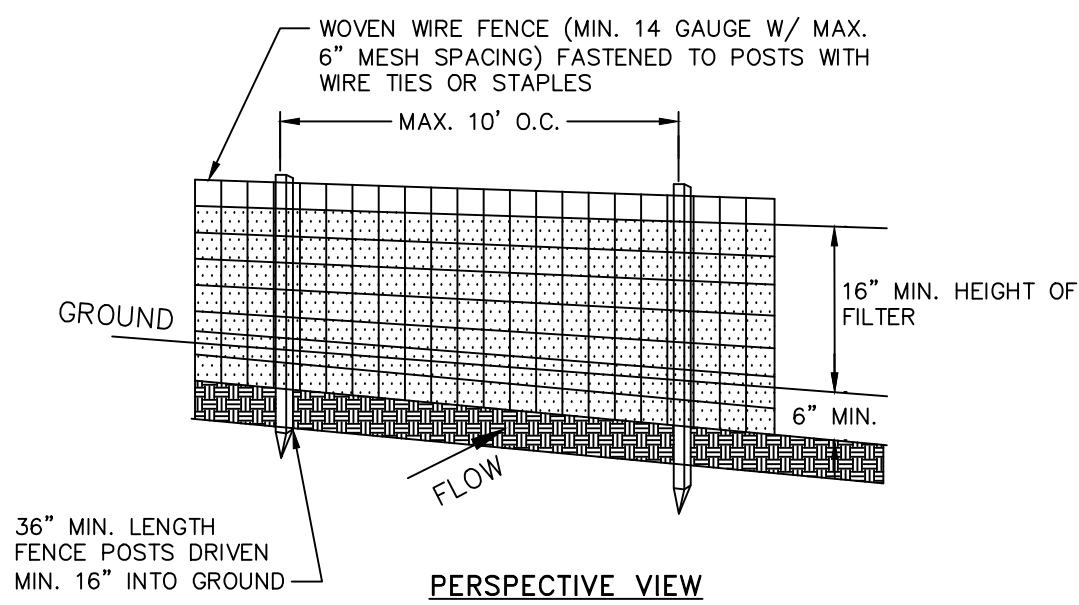

PERSPECTIVE VIEW

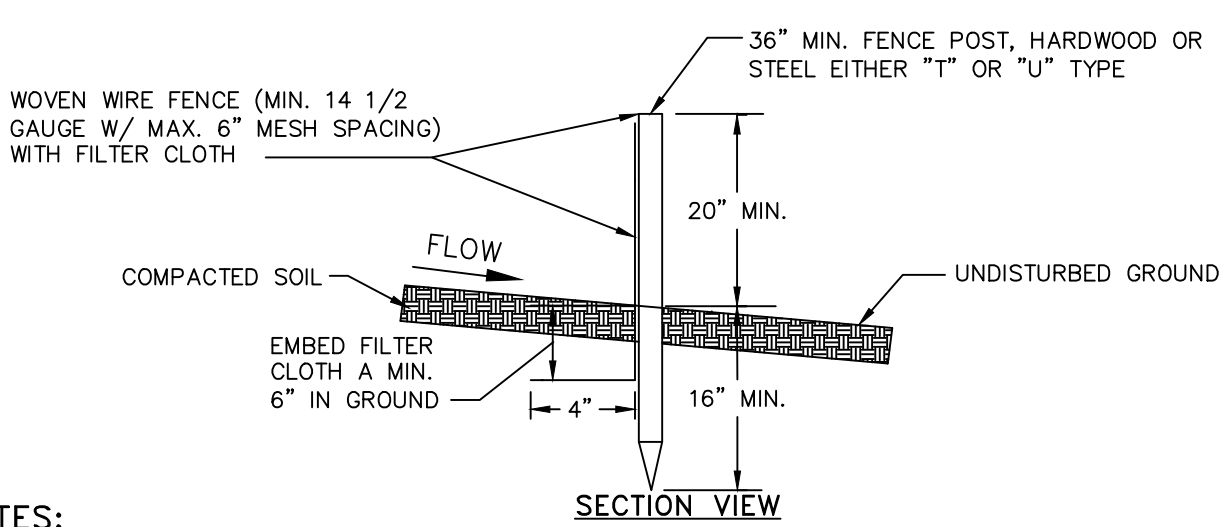

SECTION VIEW

NOTES:

- FILTER CLOTH TO BE FASTENED SECURELY TO WOVEN WIRE FENCE WITH TIES SPACED EVERY 24" AT TOP AND MID SECTION.
- WHEN TWO SECTIONS OF FILTER CLOTH ADJOIN EACH OTHER THEY SHALL BE OVER-LAPPED BY SIX INCHES AND FOLDED. FILTER CLOTH SHALL BE EITHER FILTER X, MIRAFI 100X, STABILINKA T140N OR APPROVED EQUAL.
- PREFABRICATED UNITS SHALL BE GEOTAF, ENVIROFENCE OR APPROVED EQUAL.
- MAINTENANCE SHALL BE PERFORMED AS NEEDED AND MATERIAL REMOVED WHEN "BULGES" DEVELOP IN THE SILT FENCE.

SILT FENCE DETAIL NOT TO SCALE

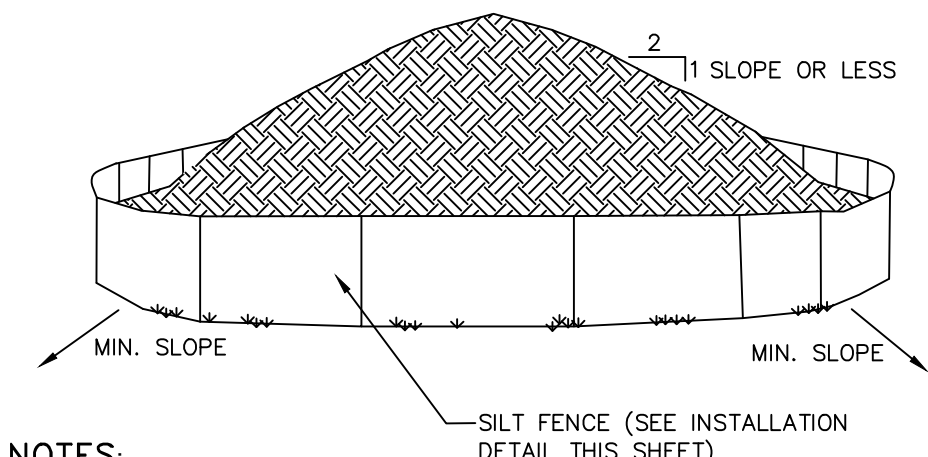

NOTES:

- AREA CHOSEN FOR STOCKPIILING OPERATIONS SHALL BE DRY AND STABLE.
- EACH PILE SHALL BE SURROUNDED WITH SILT FENCING, THEN STABILIZED WITH VEGETATION OR COVER.

TEMPORARY SOIL STOCKPILE DETAIL NOT TO SCALE

LEGEND

- EXISTING PROPERTY LINE
- PROPOSED PROPERTY LINE
- EXISTING MAJOR CONTOUR
- EXISTING MINOR CONTOUR
- EXISTING UTILITY POLE
- PROPOSED MAJOR CONTOUR
- PROPOSED MINOR CONTOUR
- PROPOSED SPOT ELEVATION
- PROPOSED SILT FENCE
- PROPOSED LIMIT OF DISTURBANCE
- PROPOSED SOIL STOCKPILE BOUNDARY

SEED:
PENALAWN RED FESCUE 25%
KENTUCKY BLUE GRASS 55%
PERENNIAL RYE 20%
(170 POUNDS PURE LIVE SEED PER ACRE)

FERTILIZER: COMMERCIAL 30-10-20, SLOW RELEASE. APPLICATION RATE AS PER MANUFACTURER'S RECOMMENDATIONS (NO MORE THAN 1LB NITROGEN PER 1000SF)

TOPSOIL: MIN. OF 4" DEPTH, A NATURAL, FERTILE, AGRICULTURAL SOIL CAPABLE OF SUSTAINING VIGOROUS PLANT GROWTH.

MULCH: LAYER OF COMMON HAY OR STRAW, 2 TONS PER ACRE

SOIL PH SHALL BE TESTED, LINE SHALL BE APPLIED AS REQUIRED TO BRING SOIL PH TO 6.5

EXISTING GRADE

SUBBASE LINE

TOPSOIL SEED, FERTILIZER AND MULCH DETAIL NOT TO SCALE

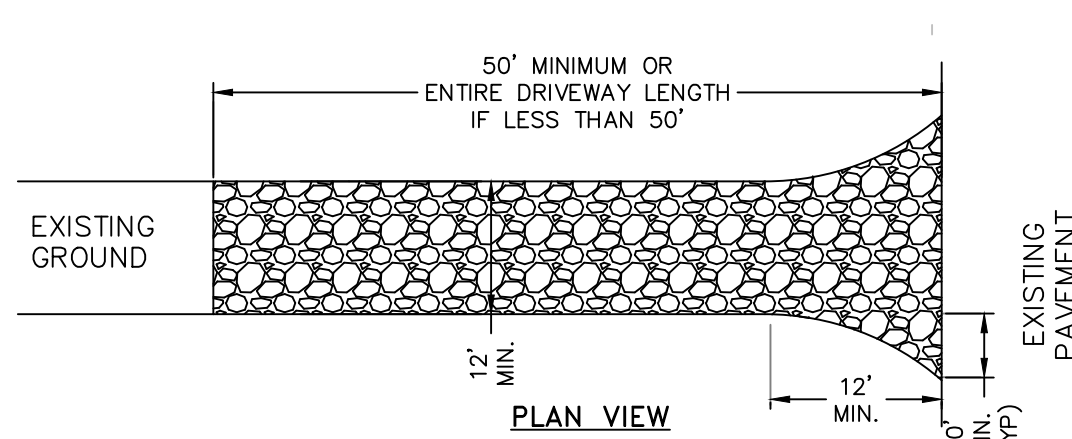

NOTES:

- STONE SIZE - USE 1-4 INCH STONE, OR RECLAIMED OR RECYCLED CONCRETE EQUIVALENT.
- THICKNESS - NOT LESS THAN SIX (6) INCHES.
- WIDTH - 12 FOOT MINIMUM, BUT NOT LESS THAN THE FULL WIDTH AT POINTS WHERE INGRESS OR EGRESS OCCURS. 24 FOOT MINIMUM IF SINGLE ENTRANCE TO SITE.
- GEOTEXTILE - WILL BE PLACED OVER THE ENTIRE AREA PRIOR TO PLACING OF STONE.
- SURFACE WATER - ALL SURFACE WATER FLOWING OR DIVERTED TOWARD CONSTRUCTION ENTRANCES SHALL BE PIPED BENEATH THE ENTRANCE. IF PIPING IS IMPRACTICAL, A MOUNTABLE BERM WITH 5:1 SLOPES WILL BE PERMITTED.
- MAINTENANCE - THE ENTRANCE SHALL BE MAINTAINED IN A CONDITION WHICH WILL PREVENT TRACKING OR FLOWING OF SEDIMENT ONTO PUBLIC RIGHTS-OF-WAY. THIS MAY REQUIRE PERIODIC TOP DRESSING WITH ADDITIONAL STONE AS CONDITIONS DEMAND AND REPAIR AND/OR CLEANOUT OF ANY MEASURE USED TO TRAP SEDIMENT. ALL SEDIMENT SPILLED, DROPPED, WASHED OR TRACTED ONTO PUBLIC RIGHTS-OF-WAY MUST BE REMOVED IMMEDIATELY.
- WHEN WASHING IS REQUIRED, IT SHALL BE DONE ON AN AREA STABILIZED WITH STONE AND WHICH DRAINS INTO AN APPROVED SEDIMENT TRAPPING DEVICE.
- PERIODIC INSPECTION AND NEEDED MAINTENANCE SHALL BE PROVIDED AFTER EACH RAIN.

STABILIZED CONSTRUCTION ENTRANCE DETAIL NOT TO SCALE

APPROVED BY RESOLUTION OF THE PLANNING BOARD OF THE CITY OF BEACON, NEW YORK, ON THE

DAY OF 20, SUBJECT TO ALL REQUIREMENTS AND CONDITIONS OF SAID RESOLUTION. ANY CHANGE, ERASURE, MODIFICATION OR REVISION OF THIS PLAT, AS APPROVED, SHALL VOID THIS APPROVAL.

SIGNED THIS DAY OF 20, BY

CHAIRMAN

SECRETARY

IN ABSENCE OF THE CHAIRMAN OR SECRETARY, THE ACTING CHAIRMAN OR ACTING SECRETARY RESPECTIVELY MAY SIGN IN THIS PLACE.

EROSION & SEDIMENT CONTROL PLAN FAIRVIEW SUBDIVISION

446 WASHINGTON AVE
CITY OF BEACON
DUTCHESS COUNTY, NEW YORK
TAX ID: 6055-82-656107 & 6055-82-645105
SCALE: 1" = 20'
DECEMBER 28, 2017

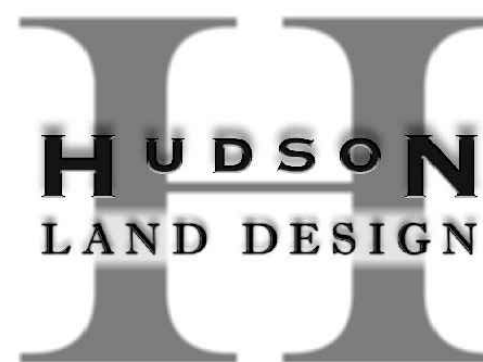

HUDSON LAND DESIGN
PROFESSIONAL ENGINEERING P.C.

174 MAIN STREET
BEACON, NEW YORK 12508
PH: 845-440-6926 F: 845-440-6637



JON D. BODENDORF, P.E.
NYS LICENSE NO. 076245
DANIEL G. KOEHLER, P.E.
NYS LICENSE NO. 082716

SHEET: 3 OF 4



DRAWN BY:	CHECKED BY:	AG	DATE	DESCRIPTION	BY
AG	DKG		2017-038		
REVISIONS:					
NO.	DATE				
1	01/30/18			REVISED LAYOUT PER UPDATED SURVEY	AG
2	02/27/18			REVISED PER CONSULTANT COMMENTS	AG
3	03/27/18			REVISED PER CONSULTANT COMMENTS	AG