

**Full Environmental Assessment Form**  
**Part 1 - Project and Setting**

**Instructions for Completing Part 1**

**Part 1 is to be completed by the applicant or project sponsor.** Responses become part of the application for approval or funding, are subject to public review, and may be subject to further verification.

Complete Part 1 based on information currently available. If additional research or investigation would be needed to fully respond to any item, please answer as thoroughly as possible based on current information; indicate whether missing information does not exist, or is not reasonably available to the sponsor; and, when possible, generally describe work or studies which would be necessary to update or fully develop that information.

Applicants/sponsors must complete all items in Sections A & B. In Sections C, D & E, most items contain an initial question that must be answered either "Yes" or "No". If the answer to the initial question is "Yes", complete the sub-questions that follow. If the answer to the initial question is "No", proceed to the next question. Section F allows the project sponsor to identify and attach any additional information. Section G requires the name and signature of the project sponsor to verify that the information contained in Part 1 is accurate and complete.

**A. Project and Sponsor Information.**

Name of Action or Project: Subdivision for BEacon Residential		
Project Location (describe, and attach a general location map): 40 North Street; Beacon, NY 12508		
Brief Description of Proposed Action (include purpose or need): 2 Lot Subdision. New Single Family Lot , Existing 4 Family 4 Family to be converted to a Two Family Dwelling and parking area for 4 cars proposed on lot 1.		
Name of Applicant/Sponsor: Beacon Residential, C/O Tim Owen.		Telephone: 845-224-8312
		E-Mail: timowen@0-tonline.net
Address: 50 Red Schoolhouse Road		
City/PO: Fishkill	State: NY	Zip Code: 12524
Project Contact (if not same as sponsor; give name and title/role):		Telephone:
		E-Mail:
Address:		
City/PO:	State:	Zip Code:
Property Owner (if not same as sponsor):		Telephone:
		E-Mail:
Address:		
City/PO:	State:	Zip Code:

## B. Government Approvals

**B. Government Approvals, Funding, or Sponsorship.** (“Funding” includes grants, loans, tax relief, and any other forms of financial assistance.)

Government Entity	If Yes: Identify Agency and Approval(s) Required	Application Date (Actual or projected)
a. City Council, Town Board, or Village Board of Trustees      yes <input checked="" type="checkbox"/> No		
b. City, Town or Village Planning Board or Commission <input checked="" type="checkbox"/> Yes <input type="checkbox"/> No	Subdivision- Planning Board Certificates of Appropriateness Site Plan Approval	December 2016
c. City Council, Town or Village Zoning Board of Appeals <input type="checkbox"/> Yes <input checked="" type="checkbox"/> No		
d. Other local agencies <input checked="" type="checkbox"/> Yes <input type="checkbox"/> No	driveway permit	
e. County agencies <input type="checkbox"/> Yes <input checked="" type="checkbox"/> No		
f. Regional agencies <input type="checkbox"/> Yes <input checked="" type="checkbox"/> No		
g. State agencies <input type="checkbox"/> Yes <input checked="" type="checkbox"/> No		
h. Federal agencies <input type="checkbox"/> Yes <input checked="" type="checkbox"/> No		
<p>i. Coastal Resources.</p> <p>i. Is the project site within a Coastal Area, or the waterfront area of a Designated Inland Waterway?      <input type="checkbox"/> Yes <input checked="" type="checkbox"/> No</p> <p>ii. Is the project site located in a community with an approved Local Waterfront Revitalization Program?      <input checked="" type="checkbox"/> Yes <input type="checkbox"/> No</p> <p>iii. Is the project site within a Coastal Erosion Hazard Area?      <input type="checkbox"/> Yes <input checked="" type="checkbox"/> No</p>		

## C. Planning and Zoning

### C.1. Planning and zoning actions.

Will administrative or legislative adoption, or amendment of a plan, local law, ordinance, rule or regulation be the only approval(s) which must be granted to enable the proposed action to proceed?      ☐ Yes ☒ No

- If Yes, complete sections C, F and G.
- If No, proceed to question C.2 and complete all remaining sections and questions in Part 1

### C.2. Adopted land use plans.

a. Do any municipally- adopted (city, town, village or county) comprehensive land use plan(s) include the site where the proposed action would be located?      ☒ Yes    No

If Yes, does the comprehensive plan include specific recommendations for the site where the proposed action would be located?      ☐ Yes ☒ No

b. Is the site of the proposed action within any local or regional special planning district (for example: Greenway Brownfield Opportunity Area (BOA); designated State or Federal heritage area; watershed management plan; or other?)      ☒ Yes ☐ No

If Yes, identify the plan(s):

---



---



---

c. Is the proposed action located wholly or partially within an area listed in an adopted municipal open space plan, or an adopted municipal farmland protection plan?      ☐ Yes ☒ No

If Yes, identify the plan(s):

---



---



---

### C.3. Zoning

a. Is the site of the proposed action located in a municipality with an adopted zoning law or ordinance. ☒ Yes ☐ No

If Yes, what is the zoning classification(s) including any applicable overlay district?

R 1-5 1- Family Residential, Zoning District; Historic and Landmark Overlay District

b. Is the use permitted or allowed by a special or conditional use permit? ☒ Yes ☐ No

c. Is a zoning change requested as part of the proposed action? ☐ Yes ☒ No

If Yes,

i. What is the proposed new zoning for the site? \_\_\_\_\_

### C.4. Existing community services.

a. In what school district is the project site located? Beacon City Schools

b. What police or other public protection forces serve the project site?

Beacon Police

c. Which fire protection and emergency medical services serve the project site?

BVAC, Beacon Fire Department

d. What parks serve the project site?

Many Local Parks serve this site including, Memorial Park, Hammond Field, Fishkill Creek Parks etc.

### D. Project Details

#### D.1. Proposed and Potential Development

a. What is the general nature of the proposed action (e.g., residential, industrial, commercial, recreational; if mixed, include all components)?

Residential

b. a. Total acreage of the site of the proposed action? 0.459 acres

b. Total acreage to be physically disturbed? 0.25 acres

c. Total acreage (project site and any contiguous properties) owned or controlled by the applicant or project sponsor? 0.459 acres

c. Is the proposed action an expansion of an existing project or use? ☐ Yes ☒ No

i. If Yes, what is the approximate percentage of the proposed expansion and identify the units (e.g., acres, miles, housing units, square feet)? % \_\_\_\_\_ Units: \_\_\_\_\_

d. Is the proposed action a subdivision, or does it include a subdivision? ☒ Yes ☐ No

If Yes,

i. Purpose or type of subdivision? (e.g., residential, industrial, commercial; if mixed, specify types)

Residential

ii. Is a cluster/conservation layout proposed? ☐ Yes ☒ No

iii. Number of lots proposed? 2

iv. Minimum and maximum proposed lot sizes? Minimum 5000 SQFT Maximum 15,000SQFT

e. Will proposed action be constructed in multiple phases? ☐ Yes ☒ No

i. If No, anticipated period of construction: \_\_\_\_\_ months

ii. If Yes:

- Total number of phases anticipated \_\_\_\_\_

- Anticipated commencement date of phase 1 (including demolition) \_\_\_\_\_ month \_\_\_\_\_ year

- Anticipated completion date of final phase \_\_\_\_\_ month \_\_\_\_\_ year

- Generally describe connections or relationships among phases, including any contingencies where progress of one phase may determine timing or duration of future phases: \_\_\_\_\_

f. Does the project include new residential uses? <span style="float: right;"><input checked="" type="checkbox"/> Yes <input type="checkbox"/> No</span> If Yes, show numbers of units proposed.				
	<u>One Family</u>	<u>Two Family</u>	<u>Three Family</u>	<u>Multiple Family (four or more)</u>
Initial Phase	1			
At completion of all phases	1			

g. Does the proposed action include new non-residential construction (including expansions)? <span style="float: right;"><input type="checkbox"/> Yes <input checked="" type="checkbox"/> No</span> If Yes,	
i. Total number of structures _____ ii. Dimensions (in feet) of largest proposed structure: _____ height; _____ width; and _____ length iii. Approximate extent of building space to be heated or cooled: _____ square feet	

h. Does the proposed action include construction or other activities that will result in the impoundment of any liquids, such as creation of a water supply, reservoir, pond, lake, waste lagoon or other storage? <span style="float: right;"><input type="checkbox"/> Yes <input checked="" type="checkbox"/> No</span> If Yes,	
i. Purpose of the impoundment: _____ ii. If a water impoundment, the principal source of the water: <input type="checkbox"/> Ground water <input type="checkbox"/> Surface water streams <input type="checkbox"/> Other specify: _____ iii. If other than water, identify the type of impounded/contained liquids and their source. _____ iv. Approximate size of the proposed impoundment. Volume: _____ million gallons; surface area: _____ acres v. Dimensions of the proposed dam or impounding structure: _____ height; _____ length vi. Construction method/materials for the proposed dam or impounding structure (e.g., earth fill, rock, wood, concrete): _____	

**D.2. Project Operations**

a. Does the proposed action include any excavation, mining, or dredging, during construction, operations, or both? (Not including general site preparation, grading or installation of utilities or foundations where all excavated materials will remain onsite) <span style="float: right;"><input type="checkbox"/> Yes <input checked="" type="checkbox"/> No</span> If Yes:	
i. What is the purpose of the excavation or dredging? _____ ii. How much material (including rock, earth, sediments, etc.) is proposed to be removed from the site? • Volume (specify tons or cubic yards): _____ • Over what duration of time? _____ iii. Describe nature and characteristics of materials to be excavated or dredged, and plans to use, manage or dispose of them. _____ _____ iv. Will there be onsite dewatering or processing of excavated materials? <span style="float: right;"><input type="checkbox"/> Yes <input type="checkbox"/> No</span> If yes, describe. _____ _____ v. What is the total area to be dredged or excavated? _____ acres vi. What is the maximum area to be worked at any one time? _____ acres vii. What would be the maximum depth of excavation or dredging? _____ feet viii. Will the excavation require blasting? <span style="float: right;"><input type="checkbox"/> Yes <input type="checkbox"/> No</span> ix. Summarize site reclamation goals and plan: _____ _____ _____	

b. Would the proposed action cause or result in alteration of, increase or decrease in size of, or encroachment into any existing wetland, waterbody, shoreline, beach or adjacent area? <span style="float: right;"><input type="checkbox"/> Yes <input checked="" type="checkbox"/> No</span> If Yes:	
i. Identify the wetland or waterbody which would be affected (by name, water index number, wetland map number or geographic description): _____ _____	

ii. Describe how the proposed action would affect that waterbody or wetland, e.g. excavation, fill, placement of structures, or alteration of channels, banks and shorelines. Indicate extent of activities, alterations and additions in square feet or acres:

\_\_\_\_\_

\_\_\_\_\_

\_\_\_\_\_

iii. Will proposed action cause or result in disturbance to bottom sediments? ☐ Yes ☐ No  
If Yes, describe: \_\_\_\_\_

iv. Will proposed action cause or result in the destruction or removal of aquatic vegetation? ☐ Yes ☐ No  
If Yes:

- acres of aquatic vegetation proposed to be removed: \_\_\_\_\_
- expected acreage of aquatic vegetation remaining after project completion: \_\_\_\_\_
- purpose of proposed removal (e.g. beach clearing, invasive species control, boat access): \_\_\_\_\_
- proposed method of plant removal: \_\_\_\_\_
- if chemical/herbicide treatment will be used, specify product(s): \_\_\_\_\_

v. Describe any proposed reclamation/mitigation following disturbance: \_\_\_\_\_

\_\_\_\_\_

c. Will the proposed action use, or create a new demand for water? ☒ Yes ☐ No  
If Yes:

i. Total anticipated water usage/demand per day: \_\_\_\_\_ 1,100 gallons/day

ii. Will the proposed action obtain water from an existing public water supply? ☒ Yes ☐ No  
If Yes:

- Name of district or service area: City Of Beacon
- Does the existing public water supply have capacity to serve the proposal? ☒ Yes ☐ No
- Is the project site in the existing district? ☒ Yes ☐ No
- Is expansion of the district needed? ☐ Yes ☒ No
- Do existing lines serve the project site? ☒ Yes ☐ No

iii. Will line extension within an existing district be necessary to supply the project? ☐ Yes ☒ No  
If Yes:

- Describe extensions or capacity expansions proposed to serve this project: \_\_\_\_\_
- Source(s) of supply for the district: \_\_\_\_\_

iv. Is a new water supply district or service area proposed to be formed to serve the project site? ☐ Yes ☒ No  
If Yes:

- Applicant/sponsor for new district: \_\_\_\_\_
- Date application submitted or anticipated: \_\_\_\_\_
- Proposed source(s) of supply for new district: \_\_\_\_\_

v. If a public water supply will not be used, describe plans to provide water supply for the project: \_\_\_\_\_

vi. If water supply will be from wells (public or private), maximum pumping capacity: \_\_\_\_\_ gallons/minute.

d. Will the proposed action generate liquid wastes? ☒ Yes ☐ No  
If Yes:

i. Total anticipated liquid waste generation per day: 1100 gallons/day

ii. Nature of liquid wastes to be generated (e.g., sanitary wastewater, industrial; if combination, describe all components and approximate volumes or proportions of each): Sanitary Wastewater

\_\_\_\_\_

iii. Will the proposed action use any existing public wastewater treatment facilities? ☒ Yes ☐ No  
If Yes:

- Name of wastewater treatment plant to be used: City of Beacon WWTP
- Name of district: City of Beacon
- Does the existing wastewater treatment plant have capacity to serve the project? ☒ Yes ☐ No
- Is the project site in the existing district? ☒ Yes ☐ No
- Is expansion of the district needed? ☐ Yes ☒ No

Page 6 of 13

<p>h. Will the proposed action generate or emit methane (including, but not limited to, sewage treatment plants, landfills, composting facilities)? <span style="float: right;"><input type="checkbox"/> Yes <input checked="" type="checkbox"/> No</span></p> <p>If Yes:</p> <p>i. Estimate methane generation in tons/year (metric): _____</p> <p>ii. Describe any methane capture, control or elimination measures included in project design (e.g., combustion to generate heat or electricity, flaring): _____</p>			
<p>i. Will the proposed action result in the release of air pollutants from open-air operations or processes, such as quarry or landfill operations? <span style="float: right;"><input type="checkbox"/> Yes <input checked="" type="checkbox"/> No</span></p> <p>If Yes: Describe operations and nature of emissions (e.g., diesel exhaust, rock particulates/dust): _____</p>			
<p>j. Will the proposed action result in a substantial increase in traffic above present levels or generate substantial new demand for transportation facilities or services? <span style="float: right;"><input type="checkbox"/> Yes <input checked="" type="checkbox"/> No</span></p> <p>If Yes:</p> <p>i. When is the peak traffic expected (Check all that apply): <input type="checkbox"/> Morning <input type="checkbox"/> Evening <input type="checkbox"/> Weekend  <input type="checkbox"/> Randomly between hours of _____ to _____.</p> <p>ii. For commercial activities only, projected number of semi-trailer truck trips/day: _____</p> <p>iii. Parking spaces: Existing _____ Proposed _____ Net increase/decrease _____</p> <p>iv. Does the proposed action include any shared use parking? <span style="float: right;"><input type="checkbox"/> Yes <input type="checkbox"/> No</span></p> <p>v. If the proposed action includes any modification of existing roads, creation of new roads or change in existing access, describe: _____</p>			
<p>vi. Are public/private transportation service(s) or facilities available within ½ mile of the proposed site? <span style="float: right;"><input type="checkbox"/> Yes <input type="checkbox"/> No</span></p> <p>vii. Will the proposed action include access to public transportation or accommodations for use of hybrid, electric or other alternative fueled vehicles? <span style="float: right;"><input type="checkbox"/> Yes <input type="checkbox"/> No</span></p> <p>viii. Will the proposed action include plans for pedestrian or bicycle accommodations for connections to existing pedestrian or bicycle routes? <span style="float: right;"><input type="checkbox"/> Yes <input type="checkbox"/> No</span></p>			
<p>k. Will the proposed action (for commercial or industrial projects only) generate new or additional demand for energy? <span style="float: right;"><input type="checkbox"/> Yes <input checked="" type="checkbox"/> No</span></p> <p>If Yes:</p> <p>i. Estimate annual electricity demand during operation of the proposed action: _____</p> <p>ii. Anticipated sources/suppliers of electricity for the project (e.g., on-site combustion, on-site renewable, via grid/local utility, or other): _____</p> <p>iii. Will the proposed action require a new, or an upgrade to, an existing substation? <span style="float: right;"><input type="checkbox"/> Yes <input type="checkbox"/> No</span></p>			
<p>l. Hours of operation. Answer all items which apply.</p> <table style="width: 100%;"> <tr> <td style="width: 50%; vertical-align: top;"> <p>i. During Construction:</p> <ul style="list-style-type: none"> <li>• Monday - Friday: _____</li> <li>• Saturday: _____</li> <li>• Sunday: _____</li> <li>• Holidays: _____</li> </ul> </td> <td style="width: 50%; vertical-align: top;"> <p>ii. During Operations:</p> <ul style="list-style-type: none"> <li>• Monday - Friday: _____</li> <li>• Saturday: _____</li> <li>• Sunday: _____</li> <li>• Holidays: _____</li> </ul> </td> </tr> </table>		<p>i. During Construction:</p> <ul style="list-style-type: none"> <li>• Monday - Friday: _____</li> <li>• Saturday: _____</li> <li>• Sunday: _____</li> <li>• Holidays: _____</li> </ul>	<p>ii. During Operations:</p> <ul style="list-style-type: none"> <li>• Monday - Friday: _____</li> <li>• Saturday: _____</li> <li>• Sunday: _____</li> <li>• Holidays: _____</li> </ul>
<p>i. During Construction:</p> <ul style="list-style-type: none"> <li>• Monday - Friday: _____</li> <li>• Saturday: _____</li> <li>• Sunday: _____</li> <li>• Holidays: _____</li> </ul>	<p>ii. During Operations:</p> <ul style="list-style-type: none"> <li>• Monday - Friday: _____</li> <li>• Saturday: _____</li> <li>• Sunday: _____</li> <li>• Holidays: _____</li> </ul>		

<p>m. Will the proposed action produce noise that will exceed existing ambient noise levels during construction, operation, or both? <span style="float: right;"><input type="checkbox"/> Yes <input checked="" type="checkbox"/> No</span></p> <p>If yes:</p> <p>i. Provide details including sources, time of day and duration:</p> <p>_____</p> <p>_____</p>	
<p>ii. Will proposed action remove existing natural barriers that could act as a noise barrier or screen? <span style="float: right;"><input type="checkbox"/> Yes <input type="checkbox"/> No</span></p> <p>Describe: _____</p> <p>_____</p>	
<p>n.. Will the proposed action have outdoor lighting? <span style="float: right;"><input checked="" type="checkbox"/> Yes <input type="checkbox"/> No</span></p> <p>If yes:</p> <p>i. Describe source(s), location(s), height of fixture(s), direction/aim, and proximity to nearest occupied structures: Entry Lighting for dwellins _____</p> <p>_____</p>	
<p>ii. Will proposed action remove existing natural barriers that could act as a light barrier or screen? <span style="float: right;"><input type="checkbox"/> Yes <input checked="" type="checkbox"/> No</span></p> <p>Describe: _____</p> <p>_____</p>	
<p>o. Does the proposed action have the potential to produce odors for more than one hour per day? <span style="float: right;"><input type="checkbox"/> Yes <input checked="" type="checkbox"/> No</span></p> <p>If Yes, describe possible sources, potential frequency and duration of odor emissions, and proximity to nearest occupied structures: _____</p> <p>_____</p> <p>_____</p>	
<p>p. Will the proposed action include any bulk storage of petroleum (combined capacity of over 1,100 gallons) or chemical products 185 gallons in above ground storage or any amount in underground storage? <span style="float: right;"><input type="checkbox"/> Yes <input checked="" type="checkbox"/> No</span></p> <p>If Yes:</p> <p>i. Product(s) to be stored _____</p> <p>ii. Volume(s) _____ per unit time _____ (e.g., month, year)</p> <p>iii. Generally describe proposed storage facilities: _____</p> <p>_____</p>	
<p>q. Will the proposed action (commercial, industrial and recreational projects only) use pesticides (i.e., herbicides, insecticides) during construction or operation? <span style="float: right;"><input type="checkbox"/> Yes <input checked="" type="checkbox"/> No</span></p> <p>If Yes:</p> <p>i. Describe proposed treatment(s):</p> <p>_____</p> <p>_____</p> <p>_____</p>	
<p>ii. Will the proposed action use Integrated Pest Management Practices? <span style="float: right;"><input type="checkbox"/> Yes <input type="checkbox"/> No</span></p>	
<p>r. Will the proposed action (commercial or industrial projects only) involve or require the management or disposal of solid waste (excluding hazardous materials)? <span style="float: right;"><input type="checkbox"/> Yes <input checked="" type="checkbox"/> No</span></p> <p>If Yes:</p> <p>i. Describe any solid waste(s) to be generated during construction or operation of the facility:</p> <ul style="list-style-type: none"> <li>• Construction: _____ tons per _____ (unit of time)</li> <li>• Operation : _____ tons per _____ (unit of time)</li> </ul> <p>ii. Describe any proposals for on-site minimization, recycling or reuse of materials to avoid disposal as solid waste:</p> <ul style="list-style-type: none"> <li>• Construction: _____</li> <li>• Operation: _____</li> </ul> <p>iii. Proposed disposal methods/facilities for solid waste generated on-site:</p> <ul style="list-style-type: none"> <li>• Construction: _____</li> <li>• Operation: _____</li> </ul>	



s. Does the proposed action include construction or modification of a solid waste management facility? ☐ Yes ☒ No

If Yes:

i. Type of management or handling of waste proposed for the site (e.g., recycling or transfer station, composting, landfill, or other disposal activities): \_\_\_\_\_

ii. Anticipated rate of disposal/processing:

- \_\_\_\_\_ Tons/month, if transfer or other non-combustion/thermal treatment, or
- \_\_\_\_\_ Tons/hour, if combustion or thermal treatment

iii. If landfill, anticipated site life: \_\_\_\_\_ years

---

t. Will proposed action at the site involve the commercial generation, treatment, storage, or disposal of hazardous waste? ☐ Yes ☒ No

If Yes:

i. Name(s) of all hazardous wastes or constituents to be generated, handled or managed at facility: \_\_\_\_\_

ii. Generally describe processes or activities involving hazardous wastes or constituents: \_\_\_\_\_

iii. Specify amount to be handled or generated \_\_\_\_\_ tons/month

iv. Describe any proposals for on-site minimization, recycling or reuse of hazardous constituents: \_\_\_\_\_

v. Will any hazardous wastes be disposed at an existing offsite hazardous waste facility? ☐ Yes ☐ No

If Yes: provide name and location of facility: \_\_\_\_\_

If No: describe proposed management of any hazardous wastes which will not be sent to a hazardous waste facility: \_\_\_\_\_

## E. Site and Setting of Proposed Action

<b>E.1. Land uses on and surrounding the project site</b>																																							
<p>a. Existing land uses.</p> <p>i. Check all uses that occur on, adjoining and near the project site.</p> <div style="display: flex; justify-content: space-between;"> <div> <input checked="" type="checkbox"/> Urban    <input checked="" type="checkbox"/> Industrial    <input checked="" type="checkbox"/> Commercial    <input checked="" type="checkbox"/> Residential (suburban)    <input type="checkbox"/> Rural (non-farm) </div> <div> <input type="checkbox"/> Forest    <input type="checkbox"/> Agriculture    <input type="checkbox"/> Aquatic    <input type="checkbox"/> Other (specify): _____ </div> </div> <p>ii. If mix of uses, generally describe: _____</p>																																							
<p>b. Land uses and covertypes on the project site.</p> <table border="1" style="width: 100%; border-collapse: collapse;"> <thead> <tr> <th style="width: 40%;">Land use or Covertypes</th> <th style="width: 15%;">Current Acreage</th> <th style="width: 25%;">Acreage After Project Completion</th> <th style="width: 20%;">Change (Acres +/-)</th> </tr> </thead> <tbody> <tr> <td>• Roads, buildings, and other paved or impervious surfaces</td> <td style="text-align: center;">.01</td> <td style="text-align: center;">0.1</td> <td style="text-align: center;">.09</td> </tr> <tr> <td>• Forested</td> <td></td> <td></td> <td></td> </tr> <tr> <td>• Meadows, grasslands or brushlands (non-agricultural, including abandoned agricultural)</td> <td></td> <td></td> <td></td> </tr> <tr> <td>• Agricultural (includes active orchards, field, greenhouse etc.)</td> <td></td> <td></td> <td></td> </tr> <tr> <td>• Surface water features (lakes, ponds, streams, rivers, etc.)</td> <td></td> <td></td> <td></td> </tr> <tr> <td>• Wetlands (freshwater or tidal)</td> <td></td> <td></td> <td></td> </tr> <tr> <td>• Non-vegetated (bare rock, earth or fill)</td> <td></td> <td></td> <td></td> </tr> <tr> <td>• Other Describe: <u>residential lawn</u></td> <td style="text-align: center;">0.449</td> <td style="text-align: center;">0.359</td> <td style="text-align: center;">.09</td> </tr> </tbody> </table>				Land use or Covertypes	Current Acreage	Acreage After Project Completion	Change (Acres +/-)	• Roads, buildings, and other paved or impervious surfaces	.01	0.1	.09	• Forested				• Meadows, grasslands or brushlands (non-agricultural, including abandoned agricultural)				• Agricultural (includes active orchards, field, greenhouse etc.)				• Surface water features (lakes, ponds, streams, rivers, etc.)				• Wetlands (freshwater or tidal)				• Non-vegetated (bare rock, earth or fill)				• Other Describe: <u>residential lawn</u>	0.449	0.359	.09
Land use or Covertypes	Current Acreage	Acreage After Project Completion	Change (Acres +/-)																																				
• Roads, buildings, and other paved or impervious surfaces	.01	0.1	.09																																				
• Forested																																							
• Meadows, grasslands or brushlands (non-agricultural, including abandoned agricultural)																																							
• Agricultural (includes active orchards, field, greenhouse etc.)																																							
• Surface water features (lakes, ponds, streams, rivers, etc.)																																							
• Wetlands (freshwater or tidal)																																							
• Non-vegetated (bare rock, earth or fill)																																							
• Other Describe: <u>residential lawn</u>	0.449	0.359	.09																																				

c. Is the project site presently used by members of the community for public recreation? i. If Yes: explain: _____	<input type="checkbox"/> Yes <input checked="" type="checkbox"/> No
d. Are there any facilities serving children, the elderly, people with disabilities (e.g., schools, hospitals, licensed day care centers, or group homes) within 1500 feet of the project site? If Yes, i. Identify Facilities: _____ _____	<input type="checkbox"/> Yes <input checked="" type="checkbox"/> No
e. Does the project site contain an existing dam? If Yes: i. Dimensions of the dam and impoundment: <ul style="list-style-type: none"> <li>• Dam height: _____ feet</li> <li>• Dam length: _____ feet</li> <li>• Surface area: _____ acres</li> <li>• Volume impounded: _____ gallons OR acre-feet</li> </ul> ii. Dam's existing hazard classification: _____ iii. Provide date and summarize results of last inspection: _____ _____	<input type="checkbox"/> Yes <input checked="" type="checkbox"/> No
f. Has the project site ever been used as a municipal, commercial or industrial solid waste management facility, or does the project site adjoin property which is now, or was at one time, used as a solid waste management facility? If Yes: i. Has the facility been formally closed? <ul style="list-style-type: none"> <li>• If yes, cite sources/documentation: _____</li> </ul> ii. Describe the location of the project site relative to the boundaries of the solid waste management facility: _____ _____	<input type="checkbox"/> Yes <input checked="" type="checkbox"/> No  <input type="checkbox"/> Yes <input type="checkbox"/> No
g. Have hazardous wastes been generated, treated and/or disposed of at the site, or does the project site adjoin property which is now or was at one time used to commercially treat, store and/or dispose of hazardous waste? If Yes: i. Describe waste(s) handled and waste management activities, including approximate time when activities occurred: _____ _____	<input type="checkbox"/> Yes <input checked="" type="checkbox"/> No
h. Potential contamination history. Has there been a reported spill at the proposed project site, or have any remedial actions been conducted at or adjacent to the proposed site? If Yes: i. Is any portion of the site listed on the NYSDEC Spills Incidents database or Environmental Site Remediation database? Check all that apply: <div style="display: flex; justify-content: space-between; align-items: flex-start;"> <div style="width: 45%;"> <input type="checkbox"/> Yes – Spills Incidents database  <input type="checkbox"/> Yes – Environmental Site Remediation database  <input type="checkbox"/> Neither database </div> <div style="width: 50%;"> Provide DEC ID number(s): _____  Provide DEC ID number(s): _____ </div> </div> ii. If site has been subject of RCRA corrective activities, describe control measures: _____ _____	<input type="checkbox"/> Yes <input checked="" type="checkbox"/> No  <input type="checkbox"/> Yes <input type="checkbox"/> No
iii. Is the project within 2000 feet of any site in the NYSDEC Environmental Site Remediation database? If yes, provide DEC ID number(s): B00130 , C314118	<input checked="" type="checkbox"/> Yes <input type="checkbox"/> No
iv. If yes to (i), (ii) or (iii) above, describe current status of site(s): C314118 - Churchill Mills, 1 East Main Street, Class N B00130 - Brunetto Cheese, 33 North Cedar Street, Class C	

v. Is the project site subject to an institutional control limiting property uses? <span style="float: right;"><input type="checkbox"/> Yes <input checked="" type="checkbox"/> No</span>	
<ul style="list-style-type: none"> <li>• If yes, DEC site ID number: _____</li> <li>• Describe the type of institutional control (e.g., deed restriction or easement): _____</li> <li>• Describe any use limitations: _____</li> <li>• Describe any engineering controls: _____</li> <li>• Will the project affect the institutional or engineering controls in place? <span style="float: right;"><input type="checkbox"/> Yes <input type="checkbox"/> No</span></li> <li>• Explain: _____</li> </ul>	
<b>E.2. Natural Resources On or Near Project Site</b>	
a. What is the average depth to bedrock on the project site? <span style="float: right;">_____ &gt;6' _____ feet</span>	
b. Are there bedrock outcroppings on the project site? <span style="float: right;"><input type="checkbox"/> Yes <input checked="" type="checkbox"/> No</span> If Yes, what proportion of the site is comprised of bedrock outcroppings? <span style="float: right;">_____ %</span>	
c. Predominant soil type(s) present on project site: <div style="display: flex; justify-content: space-between; margin-top: 5px;"> <div style="width: 60%;"> Urban </div> <div style="width: 35%; text-align: right;"> 100 % </div> </div> <div style="display: flex; justify-content: space-between; margin-top: 5px;"> <div style="width: 60%;"></div> <div style="width: 35%; text-align: right;"> % </div> </div> <div style="display: flex; justify-content: space-between; margin-top: 5px;"> <div style="width: 60%;"></div> <div style="width: 35%; text-align: right;"> % </div> </div>	
d. What is the average depth to the water table on the project site? Average: _____ feet	
e. Drainage status of project site soils: <div style="display: flex; justify-content: space-between; margin-top: 5px;"> <div style="width: 30%;"> <input type="checkbox"/> Well Drained: </div> <div style="width: 65%; text-align: right;"> _____ % of site </div> </div> <div style="display: flex; justify-content: space-between; margin-top: 5px;"> <div style="width: 30%;"> <input checked="" type="checkbox"/> Moderately Well Drained: </div> <div style="width: 65%; text-align: right;"> 100 % of site </div> </div> <div style="display: flex; justify-content: space-between; margin-top: 5px;"> <div style="width: 30%;"> <input type="checkbox"/> Poorly Drained </div> <div style="width: 65%; text-align: right;"> _____ % of site </div> </div>	
f. Approximate proportion of proposed action site with slopes: <div style="display: flex; justify-content: space-between; margin-top: 5px;"> <div style="width: 30%;"> <input type="checkbox"/> 0-10%: </div> <div style="width: 65%; text-align: right;"> _____ % of site </div> </div> <div style="display: flex; justify-content: space-between; margin-top: 5px;"> <div style="width: 30%;"> <input checked="" type="checkbox"/> 10-15%: </div> <div style="width: 65%; text-align: right;"> 100 % of site </div> </div> <div style="display: flex; justify-content: space-between; margin-top: 5px;"> <div style="width: 30%;"> <input type="checkbox"/> 15% or greater: </div> <div style="width: 65%; text-align: right;"> _____ % of site </div> </div>	
g. Are there any unique geologic features on the project site? <span style="float: right;"><input type="checkbox"/> Yes <input checked="" type="checkbox"/> No</span> If Yes, describe: _____	
h. Surface water features.	
i. Does any portion of the project site contain wetlands or other waterbodies (including streams, rivers, ponds or lakes)? <span style="float: right;"><input type="checkbox"/> Yes <input checked="" type="checkbox"/> No</span>	
ii. Do any wetlands or other waterbodies adjoin the project site? <span style="float: right;"><input type="checkbox"/> Yes <input checked="" type="checkbox"/> No</span>	
If Yes to either <i>i</i> or <i>ii</i> , continue. If No, skip to E.2.i.	
iii. Are any of the wetlands or waterbodies within or adjoining the project site regulated by any federal, state or local agency? <span style="float: right;"><input type="checkbox"/> Yes <input checked="" type="checkbox"/> No</span>	
iv. For each identified regulated wetland and waterbody on the project site, provide the following information: <div style="margin-top: 5px;"> <ul style="list-style-type: none"> <li>• Streams: Name _____ Classification _____</li> <li>• Lakes or Ponds: Name _____ Classification _____</li> <li>• Wetlands: Name _____ Approximate Size _____</li> <li>• Wetland No. (if regulated by DEC) _____</li> </ul> </div>	
v. Are any of the above water bodies listed in the most recent compilation of NYS water quality-impaired waterbodies? <span style="float: right;"><input type="checkbox"/> Yes <input checked="" type="checkbox"/> No</span> If yes, name of impaired water body/bodies and basis for listing as impaired: _____	
i. Is the project site in a designated Floodway? <span style="float: right;"><input type="checkbox"/> Yes <input checked="" type="checkbox"/> No</span>	
j. Is the project site in the 100 year Floodplain? <span style="float: right;"><input type="checkbox"/> Yes <input checked="" type="checkbox"/> No</span>	
k. Is the project site in the 500 year Floodplain? <span style="float: right;"><input type="checkbox"/> Yes <input checked="" type="checkbox"/> No</span>	
l. Is the project site located over, or immediately adjoining, a primary, principal or sole source aquifer? <span style="float: right;"><input type="checkbox"/> Yes <input checked="" type="checkbox"/> No</span> If Yes: <div style="margin-top: 5px;"> i. Name of aquifer: _____ </div>	

<p>m. Identify the predominant wildlife species that occupy or use the project site: _____</p> <p>_____</p> <p>_____</p>	
<p>n. Does the project site contain a designated significant natural community? <span style="float: right;"><input type="checkbox"/> Yes <input checked="" type="checkbox"/> No</span></p> <p>If Yes:</p> <p style="margin-left: 20px;">i. Describe the habitat/community (composition, function, and basis for designation): _____</p> <p style="margin-left: 20px;">ii. Source(s) of description or evaluation: _____</p> <p style="margin-left: 20px;">iii. Extent of community/habitat:</p> <ul style="list-style-type: none"> <li>• Currently: _____ acres</li> <li>• Following completion of project as proposed: _____ acres</li> <li>• Gain or loss (indicate + or -): _____ acres</li> </ul>	
<p>o. Does project site contain any species of plant or animal that is listed by the federal government or NYS as endangered or threatened, or does it contain any areas identified as habitat for an endangered or threatened species? <span style="float: right;">Yes <input checked="" type="checkbox"/> No <input type="checkbox"/></span></p> <p style="margin-left: 20px;">The site does not provide habitat for any endangered or threatened species</p>	
<p>p. Does the project site contain any species of plant or animal that is listed by NYS as rare, or as a species of special concern? <span style="float: right;"><input type="checkbox"/> Yes <input checked="" type="checkbox"/> No</span></p>	
<p>q. Is the project site or adjoining area currently used for hunting, trapping, fishing or shell fishing? <span style="float: right;"><input type="checkbox"/> Yes <input checked="" type="checkbox"/> No</span></p> <p>If yes, give a brief description of how the proposed action may affect that use: _____</p> <p>_____</p>	
<p><b>E.3. Designated Public Resources On or Near Project Site</b></p>	
<p>a. Is the project site, or any portion of it, located in a designated agricultural district certified pursuant to Agriculture and Markets Law, Article 25-AA, Section 303 and 304? <span style="float: right;"><input type="checkbox"/> Yes <input checked="" type="checkbox"/> No</span></p> <p>If Yes, provide county plus district name/number: _____</p>	
<p>b. Are agricultural lands consisting of highly productive soils present? <span style="float: right;"><input type="checkbox"/> Yes <input checked="" type="checkbox"/> No</span></p> <p style="margin-left: 20px;">i. If Yes: acreage(s) on project site: _____</p> <p style="margin-left: 20px;">ii. Source(s) of soil rating(s): _____</p>	
<p>c. Does the project site contain all or part of, or is it substantially contiguous to, a registered National Natural Landmark? <span style="float: right;"><input type="checkbox"/> Yes <input checked="" type="checkbox"/> No</span></p> <p>If Yes:</p> <p style="margin-left: 20px;">i. Nature of the natural landmark: <input type="checkbox"/> Biological Community <input type="checkbox"/> Geological Feature</p> <p style="margin-left: 20px;">ii. Provide brief description of landmark, including values behind designation and approximate size/extent: _____</p> <p>_____</p> <p>_____</p>	
<p>d. Is the project site located in or does it adjoin a state listed Critical Environmental Area? <span style="float: right;"><input type="checkbox"/> Yes <input checked="" type="checkbox"/> No</span></p> <p>If Yes:</p> <p style="margin-left: 20px;">i. CEA name: _____</p> <p style="margin-left: 20px;">ii. Basis for designation: _____</p> <p style="margin-left: 20px;">iii. Designating agency and date: _____</p>	

e. Does the project site contain, or is it substantially contiguous to, a building, archaeological site, or district which is listed on, or has been nominated by the NYS Board of Historic Preservation for inclusion on, the State or National Register of Historic Places?	<input checked="" type="checkbox"/> Yes <input type="checkbox"/> No
If Yes:	
i. Nature of historic/archaeological resource: <input type="checkbox"/> Archaeological Site <input checked="" type="checkbox"/> Historic Building or District	
ii. Name: <u>Howland Library</u>	
iii. Brief description of attributes on which listing is based: _____	
f. Is the project site, or any portion of it, located in or adjacent to an area designated as sensitive for archaeological sites on the NY State Historic Preservation Office (SHPO) archaeological site inventory?	<input checked="" type="checkbox"/> Yes <input type="checkbox"/> No
g. Have additional archaeological or historic site(s) or resources been identified on the project site?	<input type="checkbox"/> Yes <input checked="" type="checkbox"/> No
If Yes:	
i. Describe possible resource(s): _____	
ii. Basis for identification: _____	
h. Is the project site within five miles of any officially designated and publicly accessible federal, state, or local scenic or aesthetic resource?	<input checked="" type="checkbox"/> Yes <input type="checkbox"/> No
If Yes:	
i. Identify resource: _____	
ii. Nature of, or basis for, designation (e.g., established highway overlook, state or local park, state historic trail or scenic byway, etc.): _____	
iii. Distance between project and resource: _____ miles.	
i. Is the project site located within a designated river corridor under the Wild, Scenic and Recreational Rivers Program 6 NYCRR 666?	<input type="checkbox"/> Yes <input checked="" type="checkbox"/> No
If Yes:	
i. Identify the name of the river and its designation: _____	
ii. Is the activity consistent with development restrictions contained in 6NYCRR Part 666?	
	<input type="checkbox"/> Yes <input type="checkbox"/> No

#### F. Additional Information

Attach any additional information which may be needed to clarify your project.

If you have identified any adverse impacts which could be associated with your proposal, please describe those impacts plus any measures which you propose to avoid or minimize them.

#### G. Verification

I certify that the information provided is true to the best of my knowledge.

Applicant/Sponsor Name Tim Owen Date 8-27-17

Signature  Title President

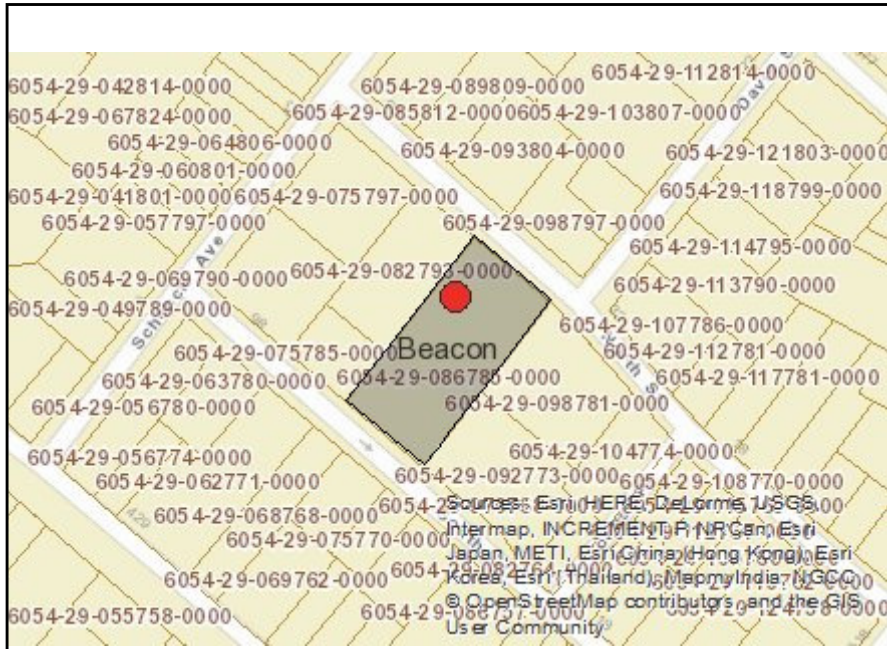

**Disclaimer:** The EAF Mapper is a screening tool intended to assist project sponsors and reviewing agencies in preparing an environmental assessment form (EAF). Not all questions asked in the EAF are answered by the EAF Mapper. Additional information on any EAF question can be obtained by consulting the EAF Workbooks. Although the EAF Mapper provides the most up-to-date digital data available to DEC, you may also need to contact local or other data sources in order to obtain data not provided by the Mapper. Digital data is not a substitute for agency determinations.



B.i.i [Coastal or Waterfront Area]	No
B.i.ii [Local Waterfront Revitalization Area]	Yes
C.2.b. [Special Planning District]	Digital mapping data are not available or are incomplete. Refer to EAF Workbook.
E.1.h [DEC Spills or Remediation Site - Potential Contamination History]	Digital mapping data are not available or are incomplete. Refer to EAF Workbook.
E.1.h.i [DEC Spills or Remediation Site - Listed]	Digital mapping data are not available or are incomplete. Refer to EAF Workbook.
E.1.h.i [DEC Spills or Remediation Site - Environmental Site Remediation Database]	Digital mapping data are not available or are incomplete. Refer to EAF Workbook.
E.1.h.iii [Within 2,000' of DEC Remediation Site]	Yes
E.1.h.iii [Within 2,000' of DEC Remediation Site - DEC ID]	B00130 , C314118
E.2.g [Unique Geologic Features]	No
E.2.h.i [Surface Water Features]	No
E.2.h.ii [Surface Water Features]	No
E.2.h.iii [Surface Water Features]	No
E.2.h.v [Impaired Water Bodies]	No
E.2.i. [Floodway]	No
E.2.j. [100 Year Floodplain]	No
E.2.k. [500 Year Floodplain]	No
E.2.l. [Aquifers]	No
E.2.n. [Natural Communities]	No
E.2.o. [Endangered or Threatened Species]	Yes

E.2.p. [Rare Plants or Animals]	No
E.3.a. [Agricultural District]	No
E.3.c. [National Natural Landmark]	No
E.3.d [Critical Environmental Area]	No
E.3.e. [National Register of Historic Places]	Yes - Digital mapping data for archaeological site boundaries are not available. Refer to EAF Workbook.
E.3.e.ii [National Register of Historic Places - Name]	Howland Library
E.3.f. [Archeological Sites]	Yes
E.3.i. [Designated River Corridor]	No