

LEGEND

- EXISTING PROPERTY LINE
- - - EXISTING ADJONER LINE
- EXISTING TREE
- EXISTING MAJOR CONTOUR
- EXISTING MINOR CONTOUR
- PROPOSED MAJOR CONTOUR
- PROPOSED MINOR CONTOUR
- PROPOSED SILT FENCE
- EXISTING FENCE
- WS EXISTING WATER MAIN
- WS EXISTING WATER SERVICE LINE
- WS PROPOSED WATER SERVICE LINE
- SMH SEWER MANHOLE
- UTILITY POLE
- HYDRANT
- WATER VALVE
- ROUND DROP INLET
- ELECTRIC METER
- UTILITY POLE WITH LIGHT
- EXISTING OVERHEAD WIRES
- EXISTING CATCH BASIN WITH INLET PROTECTION
- PROPOSED DIVERSION SWALE
- PROPOSED RETAINING WALL
- EXISTING CATCH BASIN
- PROPOSED SILT FENCE
- IMPERVIOUS SURFACE
- PROPOSED RIP RAP
- PROPOSED CONSTRUCTION ENTRANCE

EROSION AND SEDIMENT CONTROL NOTES

1. ALL EROSION CONTROL MEASURES INSTALLED DURING THE CONSTRUCTION PROCESS SHALL BE INSPECTED BY THE CONTRACTOR IN ACCORDANCE WITH THE MAINTENANCE SCHEDULE PROVIDED ON THIS SHEET. ALL EROSION CONTROL STRUCTURES SHALL BE REPAIRED AND MAINTAINED AS NECESSARY BY THE CONTRACTOR.
2. ALL STORMWATER MANAGEMENT STRUCTURES (E.G. SWALES, CULVERTS) SHALL BE REGULARLY INSPECTED FOR SEDIMENT ACCUMULATIONS. SEDIMENT AND TRASH SHALL BE REMOVED AS NECESSARY.
3. ALL EROSION CONTROL INSTALLATION AND MAINTENANCE MEASURES SHALL MEET THE REQUIREMENTS OF THE NEW YORK STANDARDS AND SPECIFICATIONS FOR EROSION AND SEDIMENT CONTROL.
4. ANY PALE OF POTENTIALLY ERODIBLE MATERIAL TEMPORARILY STOCKPILED ON THE SITE DURING THE CONSTRUCTION PROCESS SHALL BE LOCATED IN AN AREA PROTECTED BY A SERRATED SLOTTED SILT FENCE.
5. PERMANENT SEED AREAS FOR EROSION CONTROL SHALL BE IN ACCORDANCE WITH DETAIL AND SPECIFICATIONS ON THE DETAIL SHEET.
6. AREAS UNDERGOING SOIL RESTORATION SHALL BE REVEGETATED OR COMPLETED AND NOT BE RESTORED FOR A PERIOD OF 21 DAYS OR MORE SHALL BE STABILIZED WITH TEMPORARY OR PERMANENT VEGETATIVE COVER WITHIN 14 DAYS.
7. ON-SITE DUST CONTROL SHALL BE ACCOMPLISHED BY STANDARD METHODS OF LIGHTLY WATERING ALL EXPOSED SOIL AND RAPIDLY STABILIZING THE REPAIRED AREAS WITH TOPSOIL, LOAM AND/OR SEEDING.
8. THE CONTRACTOR SHALL EMPLOY SOIL RESTORATION TO ALL DISTURBED AREAS THAT WILL REMAIN LANDSCAPED.
9. FOR HEAVY TRAFFIC AREAS, FULL SOIL RESTORATION WILL BE REQUIRED. FULL SOIL RESTORATION CONSISTS OF USE OF A BULDOZER TO DEEPLY REPAIR ATTACHED TO 10" DEEPERS SHALL BE DONE DURING CONSTRUCTION AND REVEGETATED WITHIN 14 DAYS. A LOG BOOK, THE SITE LOG BOOK SHALL BE MAINTAINED ON SITE AND BE MADE AVAILABLE TO THE PERMITTING AUTHORITY, THE OWNER/CONTRACTOR SHALL, ON A MONTHLY BASIS, POST AT THE SITE A SUMMARY OF ALL EROSION AND SEDIMENT CONTROL INSPECTION REPORTS AT THE SITE IN A LOG BOOK. THE SITE LOG BOOK SHALL BE MAINTAINED ON SITE AND BE MADE AVAILABLE TO THE PERMITTING AUTHORITY, THE OWNER/CONTRACTOR SHALL, ON A MONTHLY BASIS, POST AT THE SITE A SUMMARY OF ALL EROSION AND SEDIMENT CONTROL INSPECTION REPORTS AT THE SITE IN A LOG BOOK. THE SITE LOG BOOK SHALL BE MAINTAINED ON SITE AND BE MADE AVAILABLE TO THE PERMITTING AUTHORITY, THE OWNER/CONTRACTOR SHALL, ON A MONTHLY BASIS, POST AT THE SITE A SUMMARY OF ALL EROSION AND SEDIMENT CONTROL INSPECTION REPORTS AT THE SITE IN A LOG BOOK.
10. THE CONTRACTOR OWNER SHALL MAINTAIN A RECORD OF ALL EROSION AND SEDIMENT CONTROL INSPECTION REPORTS AT THE SITE IN A LOG BOOK. THE SITE LOG BOOK SHALL BE MAINTAINED ON SITE AND BE MADE AVAILABLE TO THE PERMITTING AUTHORITY, THE OWNER/CONTRACTOR SHALL, ON A MONTHLY BASIS, POST AT THE SITE A SUMMARY OF ALL EROSION AND SEDIMENT CONTROL INSPECTION REPORTS AT THE SITE IN A LOG BOOK.
11. THE OWNER SHALL FILE A NO WITH THE NEW YORK STATE DEPARTMENT OF ENVIRONMENTAL CONSERVATION (DEC) PRIOR TO COMMENCING CONSTRUCTION ACTIVITIES AND A NOTICE OF TERMINATION (NOT) WITH THE DEC PRIOR TO COMMENCING CONSTRUCTION ACTIVITIES.
12. IF GROUNDWATER IS ENCOUNTERED DURING CONSTRUCTION ACTIVITIES, THE CONTRACTOR SHALL CONSTRUCT A DETERMINING PIT IN ACCORDANCE WITH NEW YORK STANDARDS AND SPECIFICATIONS FOR EROSION AND SEDIMENT CONTROL (AND SUMP PITS) TO FILTER WATER FOR PUMPING TO A SATISFACTORY LOCATION.
13. WHEN ALL DISTURBED AREAS ARE STABLE, ALL TEMPORARY EROSION AND SEDIMENT CONTROL MEASURES SHALL BE REMOVED PER THE APPROVAL OF THE CITY AND QUALIFIED PROFESSIONAL.
14. UPON COMPLETION OF CONSTRUCTION OF THE PARCEL (OWNER) AND SUBSEQUENTLY THE HOMEOWNERS ASSOCIATION SHALL BE RESPONSIBLE FOR THE INSPECTION AND MAINTENANCE OF THE STORMWATER MANAGEMENT SYSTEM. THE STORMWATER MANAGEMENT SYSTEM SHALL BE INSPECTED QUARTERLY AND AFTER EACH SIGNIFICANT RAINFALL EVENT. THE (OWNER) SHALL MAINTAIN A RECORD OF INSPECTION AND MAINTENANCE REPORTS AT THE SITE REFER TO THE SWMP FOR INSPECTION REQUIREMENTS AND FUTURE MAINTENANCE.

SOIL RESTORATION NOTES:

1. THE CONTRACTOR SHALL EMPLOY SOIL RESTORATION TO ALL DISTURBED AREAS THAT WILL REMAIN LANDSCAPED.
2. FOR HEAVY TRAFFIC AREAS, FULL SOIL RESTORATION WILL BE REQUIRED. FULL SOIL RESTORATION CONSISTS OF USE OF A BULDOZER TO DEEPLY REPAIR ATTACHED TO 10" DEEPERS SHALL BE DONE DURING CONSTRUCTION AND REVEGETATED WITHIN 14 DAYS. A LOG BOOK, THE SITE LOG BOOK SHALL BE MAINTAINED ON SITE AND BE MADE AVAILABLE TO THE PERMITTING AUTHORITY, THE OWNER/CONTRACTOR SHALL, ON A MONTHLY BASIS, POST AT THE SITE A SUMMARY OF ALL EROSION AND SEDIMENT CONTROL INSPECTION REPORTS AT THE SITE IN A LOG BOOK.
3. FOR LIGHT TRAFFIC AREAS, SOIL RESTORATION SHALL BE ACCOMPLISHED BY MEANS OF TILLING THE SOIL WITH A DISK TYPE TILLER PULLED BY A TRACTOR OR PLACEMENT OF TOPSOIL OVER THE EXISTING SOIL. A.G.E.L.

PHASING:

1. DISTURBED AREA = 2.35 AC.
2. THE CONTRACTOR SHALL EMPLOY SOIL RESTORATION TO ALL DISTURBED AREAS THAT WILL REMAIN LANDSCAPED.
3. SCHEDULE A PRE-CONSTRUCTION MEETING WHICH SHALL INCLUDE THE CITY ENGINEER, OWNER OR OWNER'S REPRESENTATIVE, PROJECT ENGINEER, CONTRACTOR AND SUBCONTRACTORS (IF NECESSARY) WHO ARE TO PERFORM THE CONSTRUCTION.
4. ESTABLISH THE LIMIT OF DISTURBANCE FOR PROPOSED CLEARING AND GRADING ASSOCIATED WITH THE PROPOSED DRIVEWAY, RESIDENTIAL BUILDINGS, PARKING AREAS AND STORMWATER MANAGEMENT STRUCTURES.
5. INSTALL STABILIZED CONSTRUCTION ENTRANCE AS DETICED ON THE PLAN.
6. INSTALL SILT FENCE AS SHOWN ON THIS PLAN AND IN OTHER AREAS THAT BECOME APPARENT FOLLOWING CLEARING ACTIVITIES.
7. PRIOR TO FURTHER CONSTRUCTION ACTIVITIES, THE CONTRACTOR SHALL CONTACT THE PROJECT ENGINEER TO CONDUCT A PRE-CONSTRUCTION SITE ASSESSMENT TO VERIFY THAT THE APPROPRIATE EROSION AND SEDIMENT CONTROL STRUCTURES ON THIS PLAN HAVE BEEN ADEQUATELY INSTALLED ENSURING OVERALL PREPAREDNESS OF THIS SITE FOR THE COMMENCEMENT OF CONSTRUCTION.
8. CONSTRUCTION OF RETAINING WALL ON WEST EDGE OF MAIN PROJECT AREA. FILL BEHIND WALL AS WALL IS BEING BUILT.
9. COMMENCE MASS GRADING ACTIVITIES ON PROJECT AREA FROM WILCOTT AVENUE TO THE RETAINING WALL. CONSTRUCTION MEASURES (MULCH, SEEDING) SHALL BE INSTALLED IN DISTURBED AREAS BEFORE SIGNIFICANT BLOWING PROBLEMS DEVELOP. WATER SHALL BE SPRAYED AS NEEDED, REPEAT AS NEEDED, BUT AVOID EXCESSIVE SPRAYING WHICH COULD CREATE RUNOFF AND EROSION PROBLEMS.
10. CONSTRUCT STORM SEWER SYSTEM, WATER AND SEWER UTILITIES.
11. INSTALL ALL PROFESSIONAL LANDSCAPING.
12. CONSTRUCT CURBING, MAIN DRIVE AND PARKING AREAS TO BINDER COURSE.
13. TIE SOIL IN ALL LANDSCAPING AREAS THAT HAVE PREVIOUSLY BEEN DISTURBED.
14. PAVE TOP COURSE ON MAIN DRIVE AND PARKING AREAS.
15. INSTALL ALL PROFESSIONAL LANDSCAPING.
16. REMOVE EROSION AND SEDIMENT CONTROLS WHEN CONTRIBUTING DRAINAGE AREAS HAVE BECOME STABILIZED.

GENERAL NOTE: EROSION CONTROL MEASURES SHALL BE INSPECTED AND REPAIRED AS NEEDED DURING CONSTRUCTION ACTIVITIES AND BASED ON THE MAINTENANCE SCHEDULE. ADDITIONAL EROSION CONTROL MEASURES BASED ON SITE CONDITIONS SHALL BE PROVIDED AS NECESSARY IN ORDER TO PROTECT ADJACENT PARCELS AND WATERS.

INSPECTION SCHEDULE & MAINTENANCE OF EROSION AND SEDIMENT CONTROL MEASURES

- STABILIZED CONSTRUCTION ENTRANCE:**
 INSPECT ALL AREAS THAT HAVE RECEIVED VEGETATION EVERY SEVEN DAYS AND AFTER EVERY STORM EVENT WITH RAINFALL THAT EQUALS OR EXCEEDS 0.5 INCH. MAKE ALL REPAIRS IMMEDIATELY. REMOVE SEDIMENT FROM THE UP-SLOPE FACE OF THE FENCE BEFORE IT ACCUMULATES TO A HEIGHT EQUAL TO ONE-QUARTER THE HEIGHT OF THE FENCE. IF FENCE FABRIC TEARS, BEGINS TO DECOMPOSE, OR IN ANY WAY BECOMES INEFFECTIVE, REPLACE THE AFFECTED SECTION OF FENCE IMMEDIATELY.
- SILT FENCE:**
 INSPECT FOR DAMAGE EVERY SEVEN DAYS AND AFTER EVERY STORM EVENT WITH RAINFALL THAT EQUALS OR EXCEEDS 0.5 INCH. MAKE ALL REPAIRS IMMEDIATELY. REMOVE SEDIMENT FROM THE UP-SLOPE FACE OF THE FENCE BEFORE IT ACCUMULATES TO A HEIGHT EQUAL TO ONE-QUARTER THE HEIGHT OF THE FENCE. IF FENCE FABRIC TEARS, BEGINS TO DECOMPOSE, OR IN ANY WAY BECOMES INEFFECTIVE, REPLACE THE AFFECTED SECTION OF FENCE IMMEDIATELY.
- SOIL STOCKPILE:**
 INSPECT SEDIMENT CONTROL BARRIERS (SILT FENCE) AND VEGETATION FOR DAMAGE EVERY SEVEN DAYS AND AFTER EVERY STORM EVENT WITH RAINFALL THAT EQUALS OR EXCEEDS 0.5 INCH. MAKE ALL REPAIRS IMMEDIATELY. REMOVE SEDIMENT FROM THE UP-SLOPE FACE OF THE SEDIMENT CONTROL BARRIER BEFORE IT ACCUMULATES TO A HEIGHT EQUAL TO ONE-QUARTER THE HEIGHT OF THE SEDIMENT CONTROL BARRIER. IF SEDIMENT CONTROL BARRIER TEARS, BEGINS TO DECOMPOSE, OR IN ANY WAY BECOMES INEFFECTIVE, REPLACE THE SECTION OF SEDIMENT CONTROL BARRIER IMMEDIATELY. REVEGETATE DISTURBED AREA TO STABILIZE SOIL STOCKPILE. REMOVE THE SEDIMENT CONTROL BARRIER WHEN THE SOIL STOCKPILE HAS BEEN REMOVED.
- DUST CONTROL:**
 SCHEDULE CONSTRUCTION OPERATIONS TO MINIMIZE THE AMOUNT OF DISTURBED AREAS AT ANY ONE TIME DURING THE COURSE OF WORKS. APPLY TEMPORARY SOIL STABILIZATION PRACTICES SUCH AS MULCHING, SEEDING, AND SPRAYING (WATER). STRUCTURAL MEASURES (MULCH, SEEDING) SHALL BE INSTALLED IN DISTURBED AREAS BEFORE SIGNIFICANT BLOWING PROBLEMS DEVELOP. WATER SHALL BE SPRAYED AS NEEDED, REPEAT AS NEEDED, BUT AVOID EXCESSIVE SPRAYING WHICH COULD CREATE RUNOFF AND EROSION PROBLEMS.
- CHECK DAM:**
 INSPECT CHECK DAMS EVERY SEVEN DAYS AND AFTER EVERY STORM EVENT WITH RAINFALL THAT EQUALS OR EXCEEDS 0.5 INCH. IF SIGNIFICANT EROSION OCCURS BETWEEN STRUCTURES, A LINE OF STONE OR OTHER SUITABLE MATERIAL SHOULD BE INSTALLED IN THAT PORTION OF THE CHANNEL REMOVE SEDIMENT ACCUMULATED BEHIND THE DAM AS NEEDED TO ALLOW CHANNEL TO DRAIN THROUGH THE STONE CHECK DAM AND PREVENT LARGE FLOWS FROM CARRYING SEDIMENT OVER THE DAM. REPLACE STONES AS NEEDED TO MAINTAIN THE DESIGN CROSS SECTION OF THE STRUCTURES. REMOVE CHECK DAMS AS PER APPROVAL OF THE PROJECT ENGINEER.
- EROSION CONTROL BLANKET:**
 INSPECT THE BLANKET EVERY SEVEN DAYS AND AFTER EVERY STORM EVENT WITH RAINFALL THAT EQUALS OR EXCEEDS 0.5 INCH. REPLACE WIRE STAPLES AS REQUIRED. REPAIR AND RESEED WHERE GRASSES AND DAMAGED VEGETATION IS EVIDENT. WHEN DAMAGED BEYOND REPAIR OR NO LONGER FUNCTIONING, THE BLANKET SHALL BE REPLACED.
- DEWATERING PITS:**
 INSPECT DAILY DURING OPERATION FOR CLOGGING OR OVERFLOW. CLEAR INLET AND DISCHARGE PIPES OF OBSTRUCTIONS. IF A FILTER MATERIAL BECOMES CLOGGED WITH SEDIMENT, PIT SHALL BE CLEANED AND NEW PITS SHALL BE CONSTRUCTED AS NEEDED.
- SEDIMENT TRAP:**
 SEDIMENT SHALL BE REMOVED AND THE TRAP RESTORED TO THE ORIGINAL DIMENSIONS WHEN THE SEDIMENT HAS ACCUMULATED TO ONE-HALF OF THE DESIGN DEPTH OF THE TRAP. SEDIMENT REMOVED FROM THE TRAP SHALL BE DEPOSITED IN A PROTECTED AREA IN SUCH A MANNER THAT IT WILL NOT ERODE.
- CATCH BASINS:**
 ALL CATCH BASINS SHALL BE INSPECTED AFTER EACH STORM EVENT FOR SEDIMENT ACCUMULATION, AND DEBRIS, AND REMOVE AS NECESSARY. THE INLET PROTECTION SHALL BE INSPECTED AND REPLACED AS NECESSARY. WHEN SEDIMENT ACCUMULATION WITHIN THE CATCH BASIN SWAMP REACHES 1/2 OF THE SWAMP DEPTH, IT SHALL BE REMOVED.

RECOMMENDED FOR APPROVAL:

MAYOR OF THE CITY OF BEACON _____ DATE _____

APPROVED BY RESOLUTION OF THE CITY COUNCIL OF THE CITY OF BEACON

ON THE _____ DAY OF _____ 20____

APPROVED BY RESOLUTION OF THE PLANNING BOARD OF THE CITY OF BEACON, NEW YORK, ON THE _____ DAY OF _____ 20____ SUBJECT TO ALL REQUIREMENTS AND CONDITIONS OF SAID RESOLUTION. ANY CHANGE, ERASURE, MODIFICATION OR REVISION OF THIS PLAN, AS APPROVED, SHALL VOID THIS APPROVAL.

SIGNED THIS _____ DAY OF _____ 20____ BY _____

CHAIRMAN

SECRETARY

IN ABSENCE OF THE CHAIRMAN OR SECRETARY, THE ACTING CHAIRMAN OR ACTING SECRETARY RESPECTIVELY MAY SIGN IN THIS PLACE.



REVISIONS:			
NO.	DATE	DESCRIPTION	BY

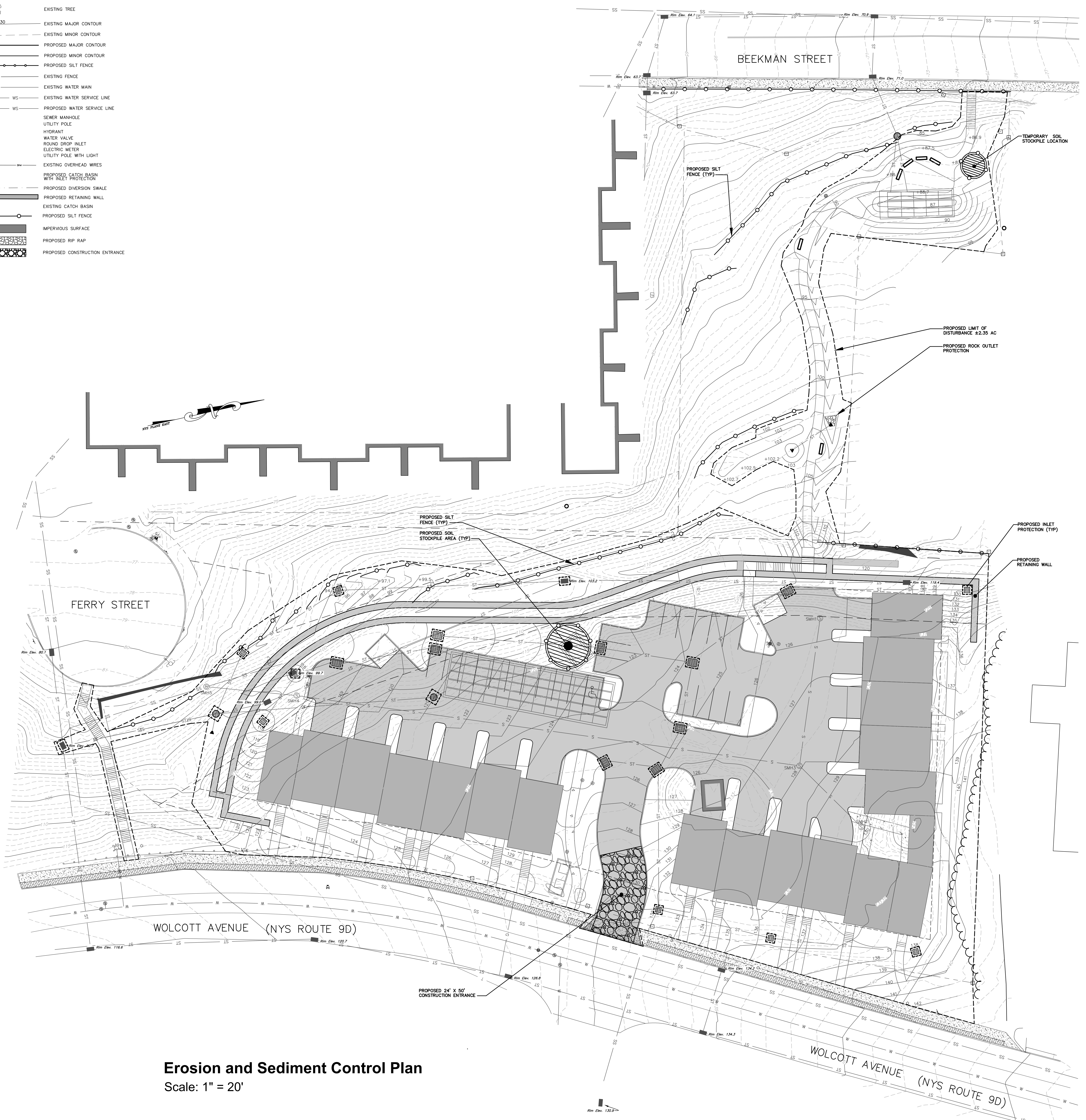

Erosion and Sediment Control Plan
 Scale: 1" = 20'