

This map was prepared for the exclusive use of and is certified only to:
BEAVER BROOK BEACON LLC
THE CITY OF BEACON

- Notes**
Copyright, 2017, by BADEY & WATSON, Surveying & Engineering, P.C.
1. All Rights Reserved. Unauthorized duplication is a violation of applicable laws.
2. No authorized alteration or addition to a document prepared by a surveyor shall be made without the signature or seal of the surveyor.
3. All certifications are valid for this map and copies thereof only if said map or copies bear the embossed seal of the surveyor whose signature is provided to these surveys. Users of this map should verify title with the County or a title insurance company.
4. This is a preliminary map of the Riding Ridge Trail and the easements shown on that certain Final Subdivision Plot of Phase 3 of Polo Field Investments, which was filed in the Dutchess County Clerk's Office on November 4, 2004 as Map No. 11042B.
5. Vertical datum hereon is Mean Sea Level (M.S.L.) (1989).
6. The State Plane Coordinate System, East Zone (NAD-1983).
7. The State Coordinate System, East Zone (NAD-1927).

AS-BUILT SURVEY
OF
RIDING RIDGE TRAIL
AND
SITUATE IN THE
CITY OF BEACON
DUTCHESS COUNTY
NEW YORK
SCALE 1 in. = 40 ft.
AUGUST 17, 2017

THE EASEMENTS SHOWN ON FILED MAP NO. 11042B
IN THE
DUTCHESS COUNTY CLERK'S OFFICE ON AUGUST 17, 2017

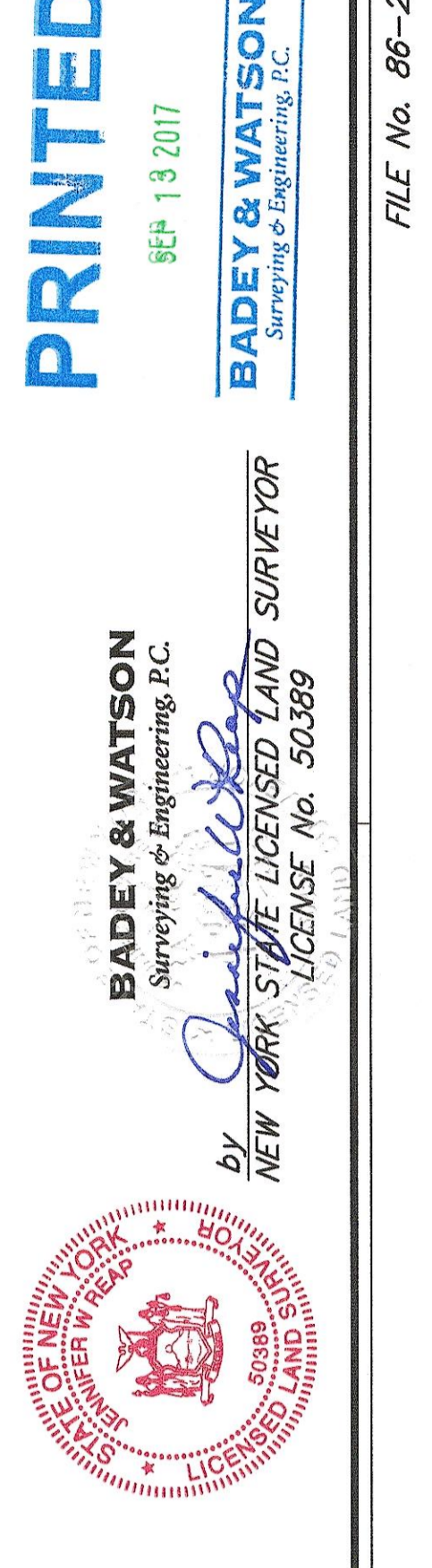

PRINTED
BY BADEY & WATSON
Surveying & Engineering, P.C.
NEW YORK STATE LICENSED LAND SURVEYOR
LICENSE No. 50369