

LIGHTING STATISTICS:

LIGHTING SCHEDULE:

Mount Height (ft)
15-16ft. (SEE PLAN)
16 ft.
14 ft.
20 ft.
20 ft.
20 ft.

- LIGHTING SCHEDULE NOTES:
1. MOUNTING HEIGHT IS AS MEASURED FROM THE GROUND TO THE SOURCE OF LIGHT OF THE FIXTURE.
  2. HOUSE-SIDE SHIELDS (HS) ARE UTILIZED ON LIGHT POLES LP-A AND LP-B.

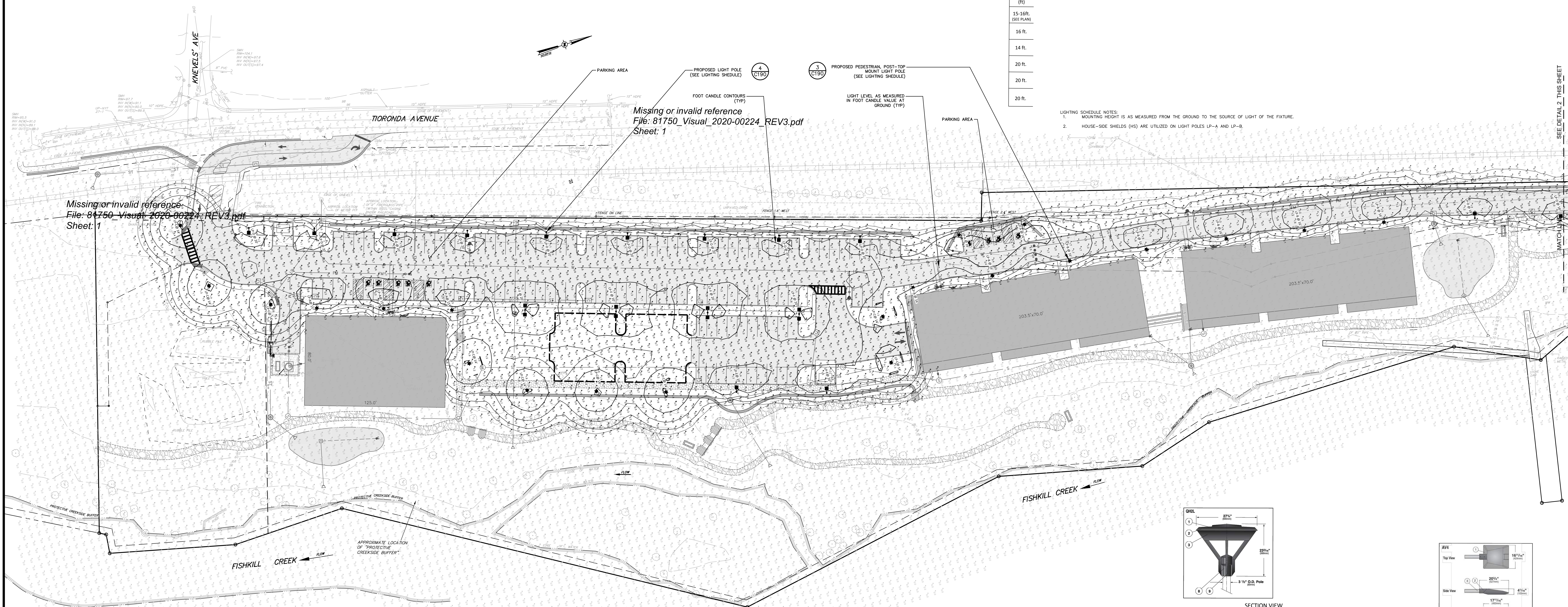

1 PHOTOMETRIC LIGHTING PLAN  
SCALE: 1" = 30'

- LIGHTING LEGEND:
- PROPOSED BUILDING
  - POST AND LUMINAIRE
  - PENDANT MOUNTED LUMINAIRE / POLE

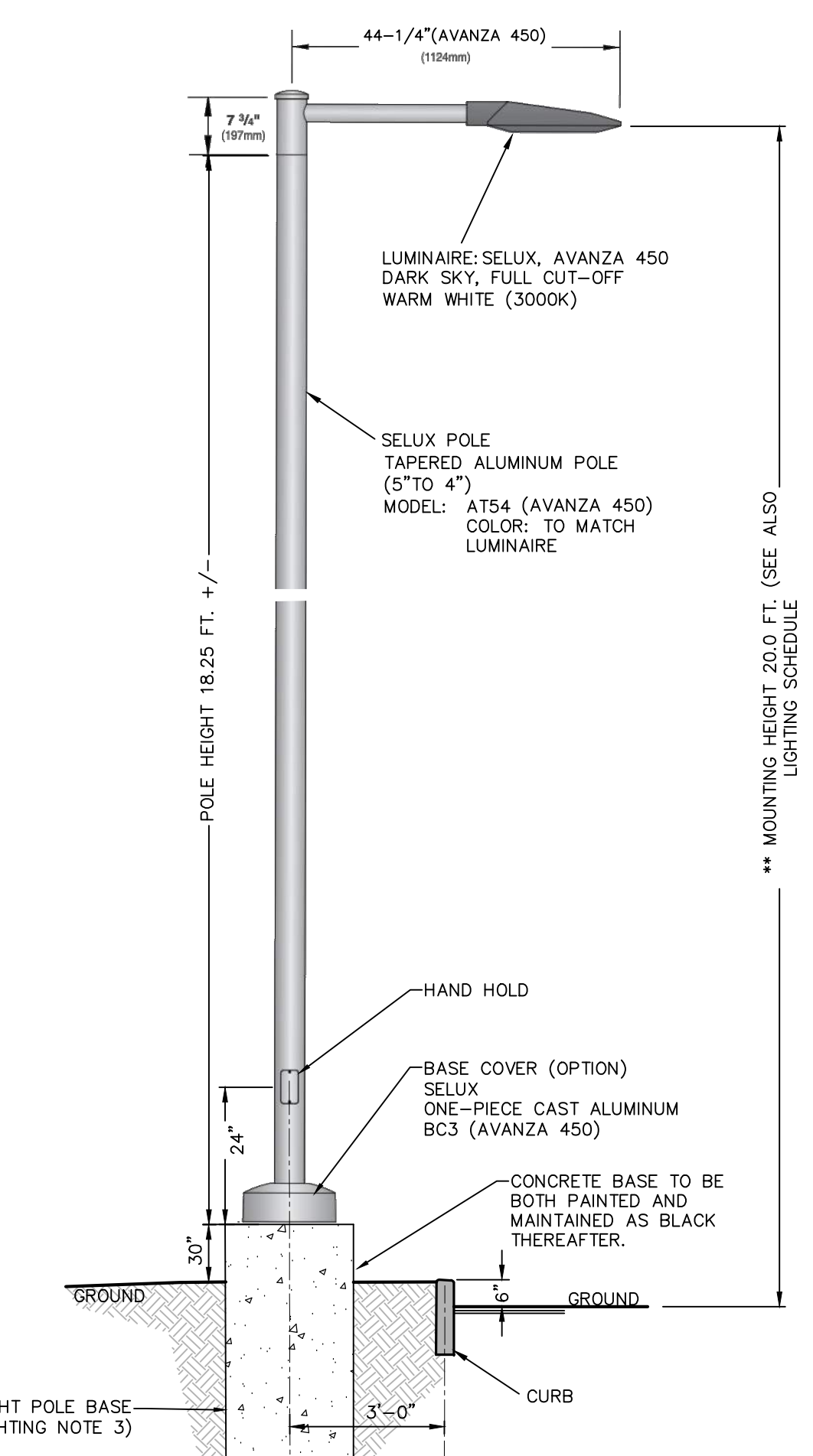
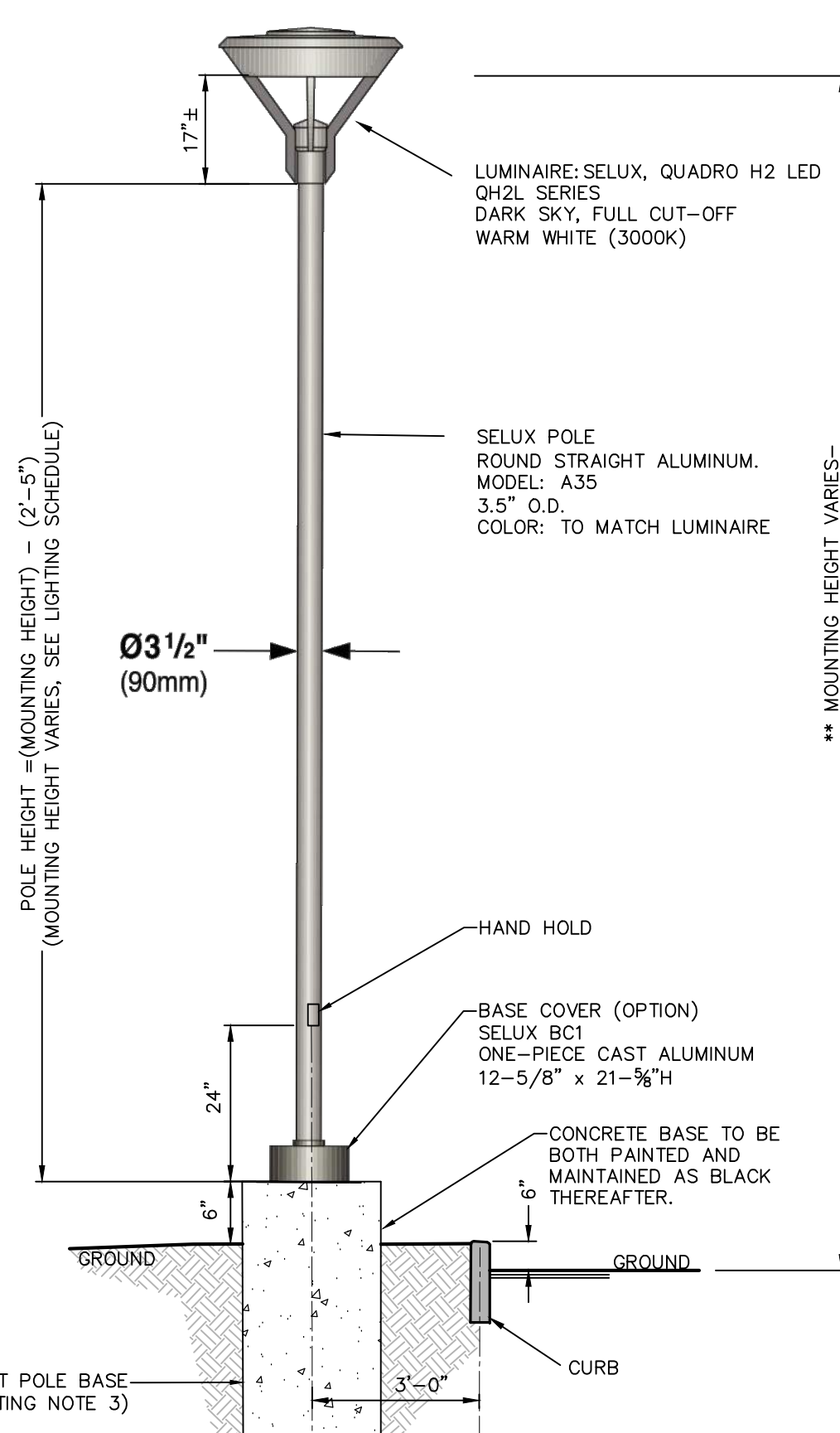
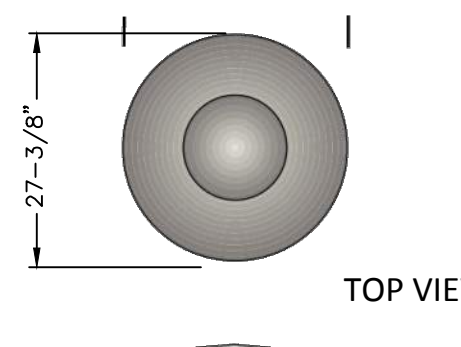
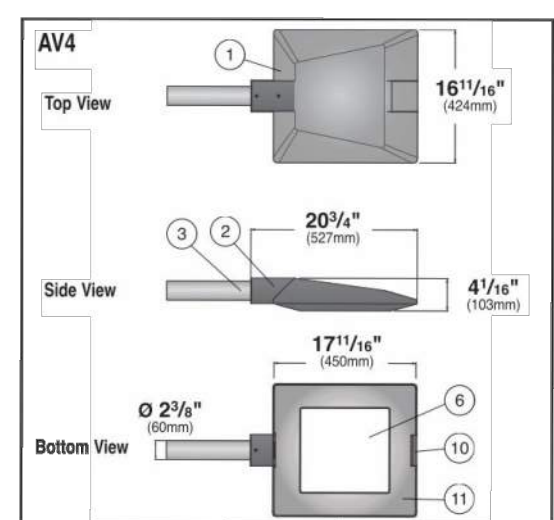
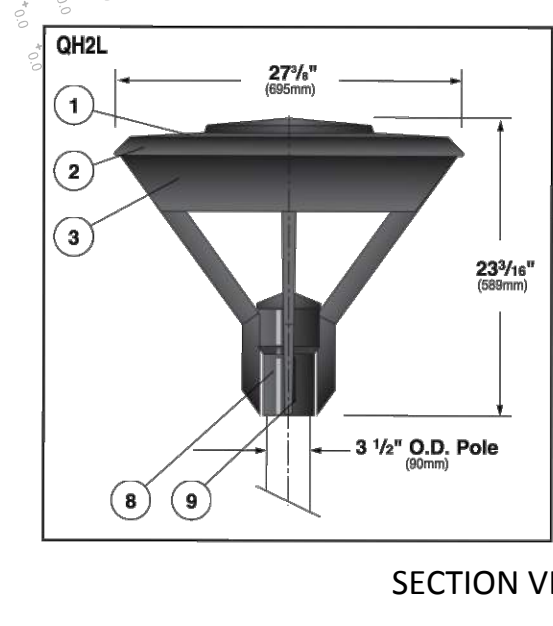

- LIGHTING NOTES:
1. PROPOSED LIGHTING AS MANUFACTURED BY SELUX LIGHTING. PROPOSED POLE LENGTHS VARY, SEE LIGHTING CHART.
  2. GRID NUMBERS SHOWN REPRESENT FOOT CANDLE VALUES AT GROUND PLANE.
  3. THE LIGHTING FIXTURES, SURFACE LOCATIONS AND ASSOCIATED PHOTOMETRIC VALUES ARE IDENTIFIED BY THE CHAZEN COMPANIES. DETAILED DESIGN OF THE LIGHTING SPECIFICATIONS, FOUNDATION DESIGN, WIRING, AND CONTROL CIRCUITRY SHALL BE BY OTHERS.
  4. IF DISCREPANCIES EXIST BETWEEN THE LIGHTING SCHEDULE AND LIGHTING PLAN, THE PLAN SHALL DICTATE.
  5. THE EXISTING STREET LIGHTS IN THE RIGHT-OF-WAYS HAVE NOT BEEN INCLUDED IN THIS PHOTOMETRIC ANALYSIS. THE LIGHT LEVELS SHOWN HEREON REFLECT THE PROPOSED LIGHTING ON SITE.

- NOTES:
1. CONTRACTOR SHALL SUBMIT SHOP DRAWINGS TO THE ENGINEER FOR APPROVAL PRIOR TO INSTALLATION.
  2. ALL EXCAVATIONS SHALL BE BACKFILLED WITH STRUCTURAL FILL AND COMPACTED TO 95% OF MAXIMUM MATERIAL DENSITY.
  3. ELECTRICAL POWER SUPPLY, WIRE, AND CONDUIT BY OTHERS.

3 PEDESTRIAN SCALE LIGHTING FIXTURE DETAIL  
SCALE: N.T.S.

- NOTES:
1. CONTRACTOR SHALL SUBMIT SHOP DRAWINGS TO THE ENGINEER FOR APPROVAL PRIOR TO INSTALLATION.
  2. ALL EXCAVATIONS SHALL BE BACKFILLED WITH STRUCTURAL FILL AND COMPACTED TO 95% OF MAXIMUM MATERIAL DENSITY.
  3. ELECTRICAL POWER SUPPLY, WIRE, AND CONDUIT BY OTHERS.
  4. WHEN LIGHT FIXTURE IS ADJACENT TO PARKING, BASE HEIGHT TO BE 30" MIN.

4 PARKING AREA LIGHTING FIXTURE DETAIL  
SCALE: N.T.S.

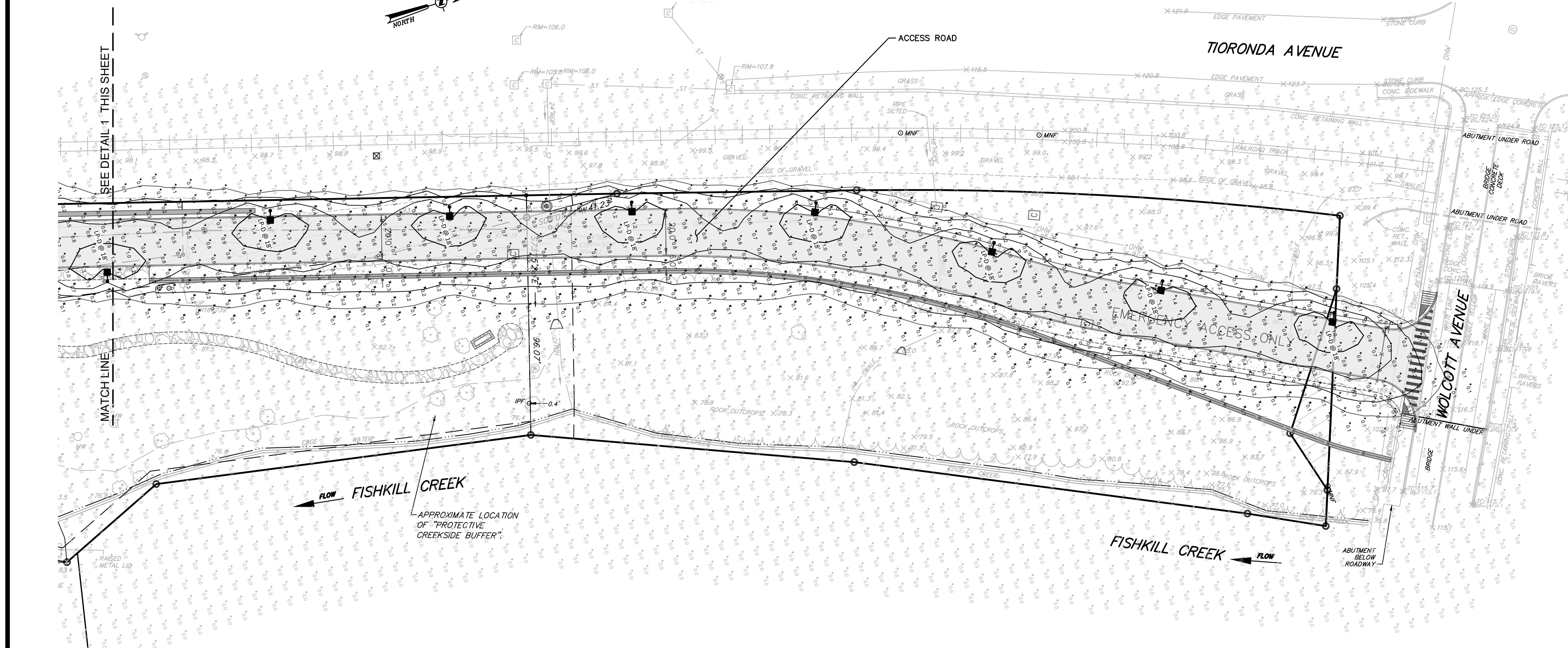

2 PHOTOMETRIC LIGHTING PLAN  
SCALE: 1" = 30'

**dig safely New York**  
Call Before You Dig  
Mark the Requested Time  
Confirm Utility Response  
Request the Marks  
Dig with Care  
800-962-7962  
www.digsaferenewyork.com

ALL RIGHTS RESERVED. COPY OR REPRODUCTION OF THIS DRAWING OR DOCUMENT OR ANY PORTION THEREOF WITHOUT THE EXPRESS WRITTEN PERMISSION OF CHAZEN ENGINEERING, LAND SURVEYING & LANDSCAPE ARCHITECTURE CO., L.P. IS PROHIBITED. THIS DRAWING OR DOCUMENT IS NOT INTENDED OR REPRESENTED TO BE SUITABLE FOR ANY PURPOSE OTHER THAN THE DESIGN OR DOCUMENTATION FOR THE PROJECT AND SHOULD BE USED ONLY FOR THE PROJECT AND FOR WHICH IT WAS INTENDED. ANY USE FOR WHICH IT WAS INTENDED, WILL BE AT USER'S SOLE RISK AND WITHOUT LIABILITY TO CHAZEN ENGINEERING, LAND SURVEYING & LANDSCAPE ARCHITECTURE CO., L.P.  
IT IS A VIOLATION OF NEW YORK STATE EDUCATION LAW FOR ANY PERSON TO ALTER THIS DRAWING OR DOCUMENT IN ANY MANNER UNLESS HE OR SHE IS ACTING UNDER THE DIRECTION OF A LICENSED DESIGN PROFESSIONAL (PROFESSIONAL ENGINEER, LAND SURVEYOR, ARCHITECT OR LANDSCAPE ARCHITECT). IF THIS DRAWING OR DOCUMENT IS ALTERED, THE ALTERING DESIGN PROFESSIONAL SHALL ATTACH TO THE DRAWING OR DOCUMENT ONE OF HIS OR HER SEAL, THE WORDS "ALTERED BY" FOLLOWED BY HIS OR HER SIGNATURE, THE DATE OF SUCH ALTERATION, AND A SPECIFIC DESCRIPTION OF THE ALTERATION.

**The Chazen Companies**  
Proud to be Employee Owned  
Engineers  
Land Surveyors  
Planners  
Environmental & Safety Professionals  
Landscape Architects

**CHAZEN ENGINEERING, LAND SURVEYING & LANDSCAPE ARCHITECTURE CO., D.P.C.**  
*Office Locations:*  
Dutchess County Office: 31 Via Street, Poughkeepsie, New York 12601, Phone (845) 644-3300  
North Country Office: 22 Elm Street, Suite 110, Glen Falls, New York 12801, Phone (518) 812-0013  
Westchester NY Office: 1 North Broadway, Suite 803, White Plains, New York 10601, Phone (914) 997-8300  
Nassauville Tennessee Office: 2416 2nd Ave S, Suite 103, Nashville, Tennessee 37212, Phone (615) 380-1568  
Chattanooga Tennessee Office: 437 E. 9th St. (Glen 203), Chattanooga, Tennessee 37403, Phone (423) 241-6275

REV.	DATE	DESCRIPTION
3	02/22/20	REVISED PER PLANNING BOARD COMMENTS
2	02/26/20	REVISED PER P.R. COMMENT AND GENERAL LAYOUT UPDATES
1	12/25/19	THIS SHEET ADDED.

designed checked  
SMD SMD  
date scale  
09/10/18 1" = 30'  
PROJECT NO.  
81750.00  
SHEET NO.  
C190  
10 of 10