

LIGHTING STATISTICS:

Statistics						
Description	Symbol	Avg	Max	Min	Max/Min	Avg/Min
Stat Zone #3 Access Road only	+	0.8 fc	1.9 fc	0.2 fc	9.5:1	4.0:1
Stat Zone #1 TO PL	X	0.3 fc	2.6 fc	0.0 fc	N/A	N/A
Stat Zone #2 Parking areas	X	1.0 fc	2.6 fc	0.0 fc	N/A	N/A

LIGHTING SCHEDULE:

Schedule	Mounting Height	Plan Designation	Quantity	Label (Not Shown on Plan)	Color Temperature CCT	Color Rendering Index CRI (Ra)	Catalog Number	Description	Manufacturer	Number Luminaire	Filename	Lumens Per Luminaire	Light Loss Factor	Wattage
15 ft.	LP-A	3	QH2L-R4-530_HS	3000K	82.9	QH2L-X-R4-SG350-30-XX-UVW-HS	Gray formed aluminum housing, clear/frosted plastic optics—2019	Selux Corporation	1	QH2L-X-R4-SG350-30-XX-UVW-HS.ies	3119	0.94	49.29	
16 ft.	LP-B	7	QH2L-R4-350_HS	3000K	82.9	QH2L-X-R4-SG350-30-XX-UVW-HS	Gray formed aluminum housing, clear/frosted plastic optics—2019	Selux Corporation	1	QH2L-X-R4-SG350-30-XX-UVW-HS.ies	2207	0.94	32.87	
14 ft.	LP-C	9	QH2L-SR5-350	3000K	82.9	QH2L-X-RSR-SG350-30-XX-UVW	Gray formed aluminum housing, clear/frosted plastic optics	Selux Corporation	1	QH2L-X-RSR-SG350-30-XX-UVW.ies	3257	0.94	32.62	
20 ft.	LP-D	19	AV4_700-R3W	3000K	80	AV4-S1-0P-L105-R3W-30-120 SX 936 41.9 /CF	Avanza 450 w/ 0° Tilt—2019	Selux (pre-rated) Copyright Selux V	1	AV4-S1-0P-L105-R3W-30-120.ies	2299	0.94	38	
20 ft.	LP-E	2	AV4-105-R3W	3000K	80	AV4-S1-0P-L105-R3W-30-120 SX 936 41.9 /CF	Avanza 450 w/ 0° Tilt	Selux (pre-rated) Copyright Selux V	1	AV4-S1-0P-L105-R3W-30-120.ies	3565	0.94	56	
20 ft.	LP-F	4	2-AV4-105-R3W	3000K	80	AV4-S1-0P-L105-R3W-30-120 SX 936 41.9 /CF	Avanza 450 w/ 0° Tilt	Selux (pre-rated) Copyright Selux V	1	AV4-S1-0P-L105-R3W-30-120.ies	3565	0.94	112	

LIGHTING SCHEDULE NOTES:
 1. MOUNTING HEIGHT IS AS MEASURED FROM THE GROUND TO THE SOURCE OF LIGHT OF THE FIXTURE.
 2. HOUSE-SIDE SHIELDS (HS) ARE UTILIZED ON LIGHT POLES LP-A AND LP-B.



1 PHOTOMETRIC LIGHTING PLAN
 SCALE: 1"=30'

LIGHTING LEGEND:

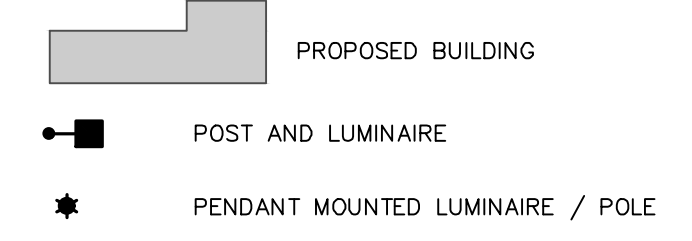

LIGHTING NOTES:

- PROPOSED LIGHTING AS MANUFACTURED BY SELUX LIGHTING. PROPOSED POLE LENGTHS VARY. SEE LIGHTING CHART.
- GRID NUMBERS SHOWN REPRESENT FOOT CANDLE VALUES AT GROUND PLANE.
- THE LIGHTING FIXTURES, SURFACE LOCATIONS AND ASSOCIATED PHOTOMETRIC VALUES ARE IDENTIFIED BY THE CHAZEN COMPANIES. DETAILED DESIGN OF THE LIGHTING SPECIFICATIONS, FOUNDATION DESIGN, WIRING, AND CONTROL CIRCUITRY SHALL BE BY OTHERS.
- IF DISCREPANCIES EXIST BETWEEN THE LIGHTING SCHEDULE AND LIGHTING PLAN, THE PLAN SHALL DICTATE.
- THE EXISTING STREET LIGHTS IN THE RIGHT-OF-WAYS HAVE NOT BEEN INCLUDED IN THIS PHOTOMETRIC ANALYSIS. THE LIGHT LEVELS SHOWN HEREON REFLECT THE PROPOSED LIGHTING ON SITE.

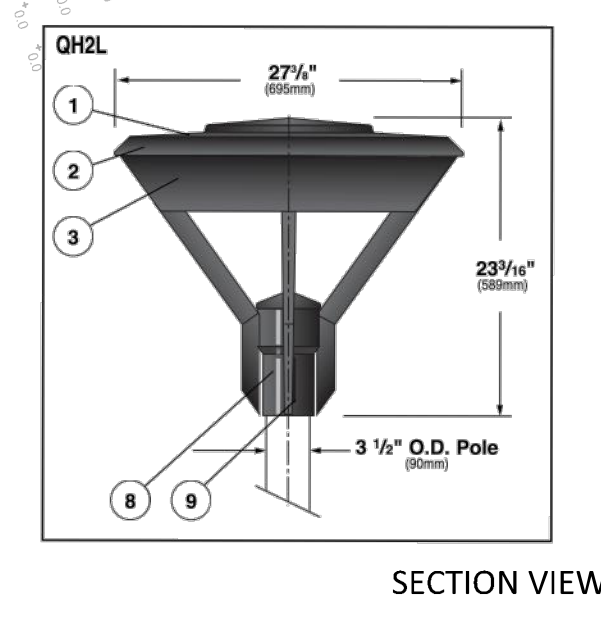

SECTION VIEW

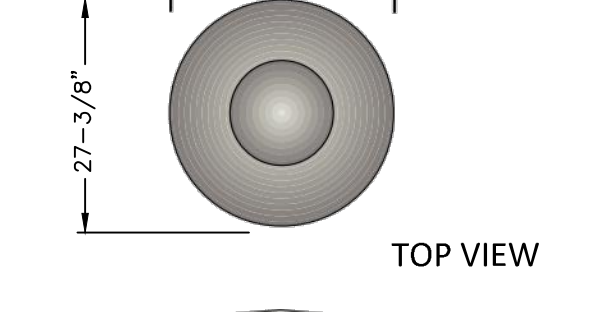

TOP VIEW

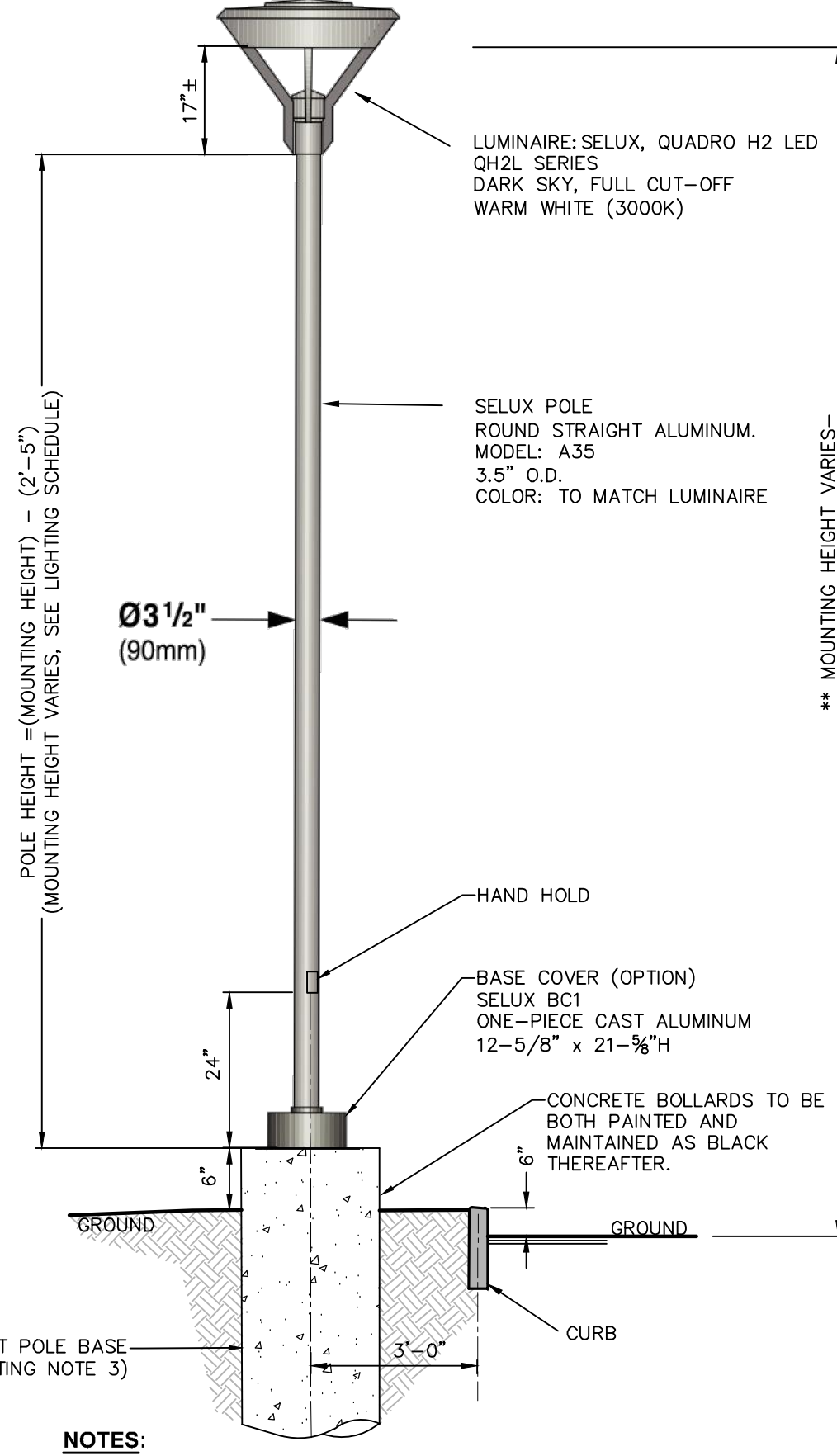

3 PEDESTRIAN SCALE LIGHTING FIXTURE DETAIL
 SCALE: N.P.C.

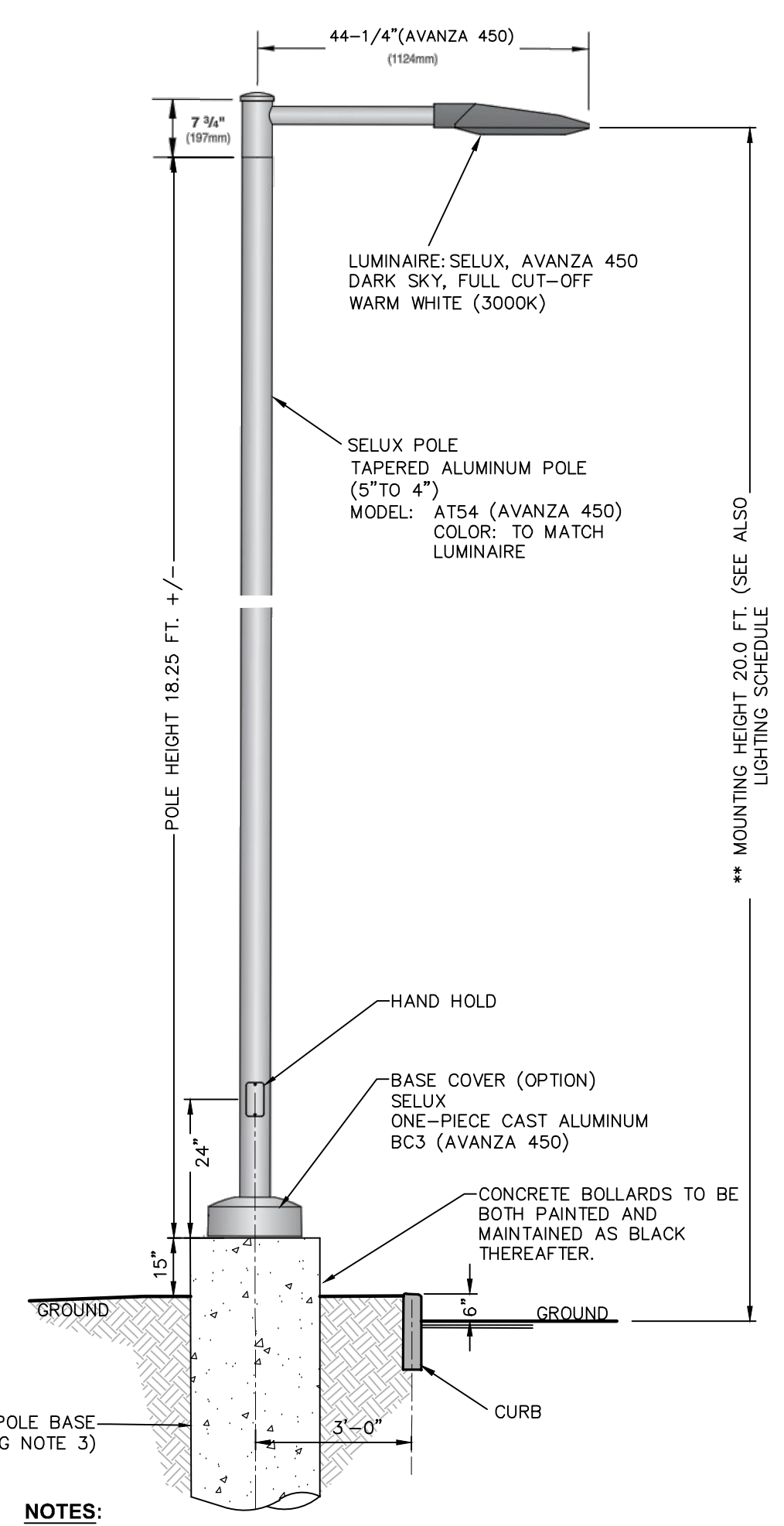

4 PARKING AREA LIGHTING FIXTURE DETAIL
 SCALE: N.P.C.

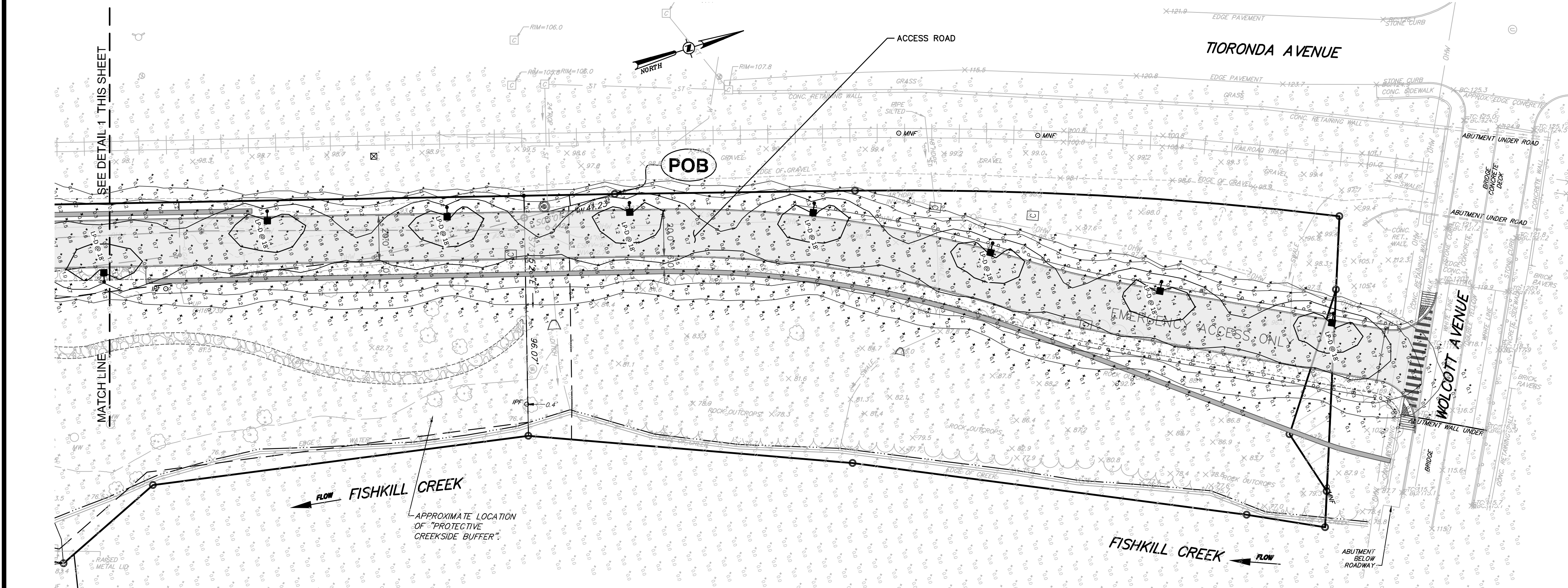

2 PHOTOMETRIC LIGHTING PLAN
 SCALE: 1"=30'

Dig Safely. New York
 Call Before You Dig
 800-962-7962
 www.digsafely.com

ALL RIGHTS RESERVED. COPY OR REPRODUCTION OF THIS DRAWING OR DOCUMENT OR ANY PORTION THEREOF WITHOUT THE EXPRESS WRITTEN PERMISSION OF CHAZEN ENGINEERING, LAND SURVEYING & LANDSCAPE ARCHITECTURE, INC. IS PROHIBITED. THIS DRAWING OR DOCUMENT IS NOT INTENDED OR REPRESENTED TO BE SUITABLE FOR ANY PURPOSE OTHER THAN THAT SPECIFICALLY STATED ON THE DRAWING OR DOCUMENT. ANY USE FOR ANY OTHER PURPOSE, ANY MODIFICATION OF THIS DRAWING OR DOCUMENT, AND USE FOR ANY PURPOSE FOR WHICH IT WAS NOT INTENDED, ARE NOT AUTHORIZED. THE USER SHALL BE RESPONSIBLE FOR OBTAINING ALL NECESSARY PERMITS AND APPROVALS FROM ALL APPLICABLE AGENCIES AND AUTHORITIES. THE USER SHALL BE RESPONSIBLE FOR OBTAINING ALL NECESSARY PERMITS AND APPROVALS FROM ALL APPLICABLE AGENCIES AND AUTHORITIES. THE USER SHALL BE RESPONSIBLE FOR OBTAINING ALL NECESSARY PERMITS AND APPROVALS FROM ALL APPLICABLE AGENCIES AND AUTHORITIES.

THE CHAZEN COMPANIES
 CHAZEN ENGINEERING, LAND SURVEYING & LANDSCAPE ARCHITECTURE, INC.
 248 TORONDA AVE., BEACON, NY 12508
 (845) 361-1300

CHAZEN ENGINEERING, LAND SURVEYING & LANDSCAPE ARCHITECTURE, INC.
 Office Locations:
 North Country Office: 20 Elm Street, Suite 110, Glen Falls, NY 12033
 Westchester NY Office: 1 North Broadway, Suite 803, White Plains, NY 10601
 Southwestern Tennessee Office: 437 E. 5th St., Suite 203, Chattanooga, TN 37403

CHAZEN ENGINEERING, LAND SURVEYING & LANDSCAPE ARCHITECTURE, INC.
 Office Locations:
 Nashville Tennessee Office: 2418 21st Ave S., Suite 1033, Nashville, Tennessee 37212
 Chattanooga Tennessee Office: 437 E. 5th St., Suite 203, Chattanooga, Tennessee 37403

REV.	DATE	DESCRIPTION
2	09/28/20	REVISED PER P.R. COMMENT AND GENERAL LAYOUT UPDATES
1	12/20/19	THIS SHEET ADDED.

248 TORONDA AVE., BEACON, N.Y.
PHOTOMETRIC LIGHTING PLAN
 CITY OF BEACON, DUTCHESS COUNTY, NEW YORK

designed: []
 checked: []
 date: 09/10/18
 scale: 1" = 30'
 project no.: 81750.00
 sheet no.: C190
 of 17