

NOT FOR CONSTRUCTION

COPYRIGHT © 2019 BY JMC. All rights reserved. No part of this document may be reproduced, stored in a retrieval system, or transmitted in any form or by any means, electronic, mechanical, photocopying, recording, or otherwise, without the prior written permission of JMC Planning, Engineering, Landscape Architecture & Land Surveying, PLLC. Any modification or alteration to this document without the prior written permission of JMC Planning, Engineering, Landscape Architecture & Land Surveying, PLLC is prohibited.

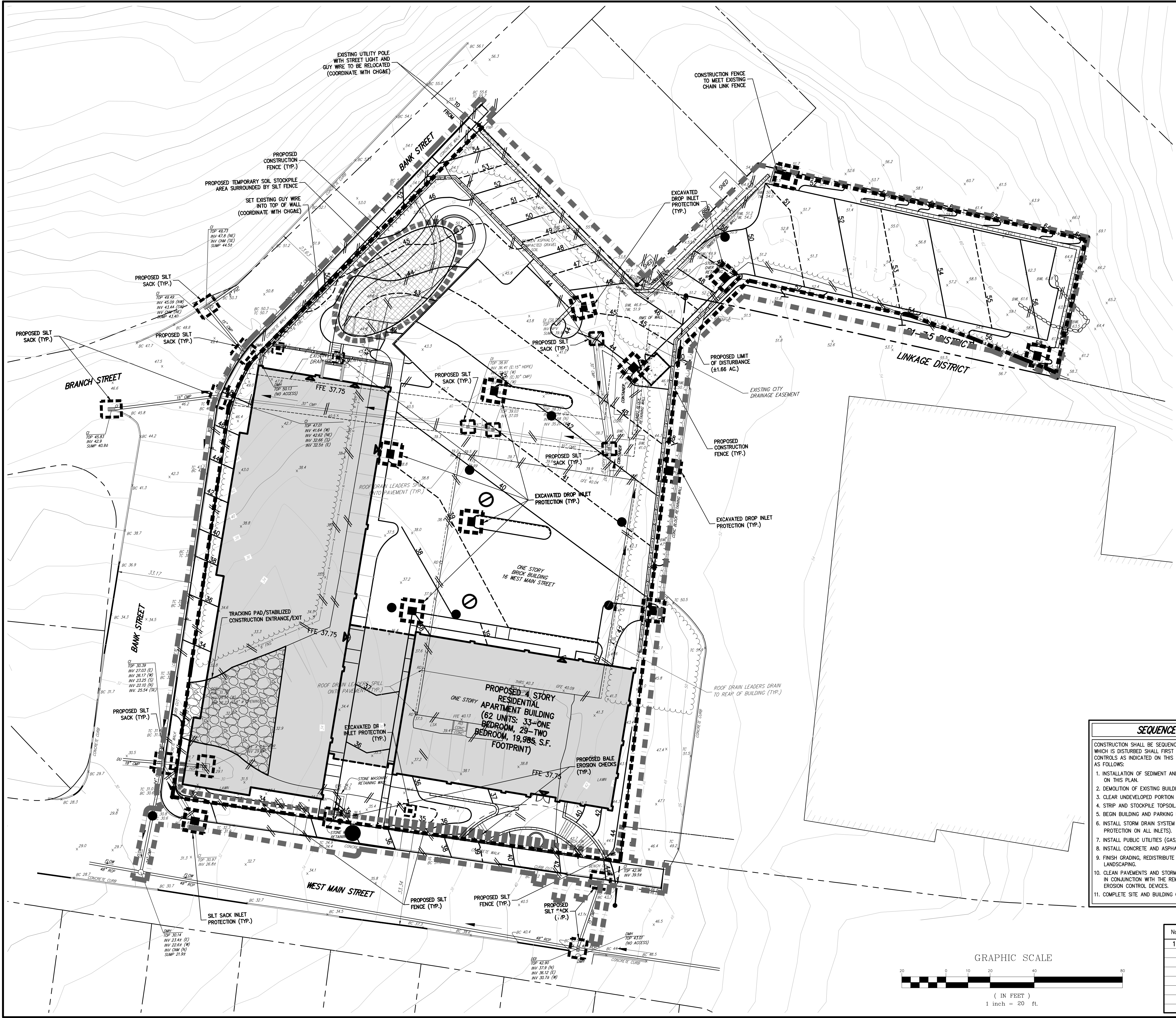

LEGEND

- PROPOSED INLET PROTECTION
- PROPOSED CONSTRUCTION FENCE
- PROPOSED SILT FENCE
- PROPOSED BALE EROSION CHECKS
- PROPOSED LIMIT OF DISTURBANCE
- PROPOSED STABILIZED CONSTRUCTION ENTRANCE
- PROPOSED STOCKPILE AREA
- EXISTING FEATURE TO BE REMOVED

- NOTES:**
- EXISTING CONDITIONS DEPICTED ON THIS PLAN HAVE BEEN TAKEN FROM SURVEY TITLED, "TOPOGRAPHIC SURVEY," PREPARED BY JMC PLANNING ENGINEERING LANDSCAPE ARCHITECTURE & LAND SURVEYING, PLLC, DATED 09/20/2018, REVISED 09/23/2019.
 - THIS PLAN IS FOR TEMPORARY EROSION AND SEDIMENT CONTROL INFORMATION ONLY.
 - PRIOR TO BEGINNING ANY CLEARING, GRUBBING OR EXCAVATION, ALL EROSION AND SEDIMENT CONTROL MEASURES SHALL BE INSTALLED IN ACCORDANCE WITH ALL THE PLANS AND SPECIFICATIONS. EROSION AND SEDIMENT CONTROL MEASURES SHALL BE MAINTAINED UNTIL THE SITE IS STABILIZED. FINAL STABILIZATION OF LANDSCAPED AREAS SHALL BE IN ACCORDANCE WITH THE LANDSCAPE PLAN.
 - THE CONTRACTOR SHALL INSPECT AND MAINTAIN ON-SITE EROSION AND SEDIMENT CONTROL MEASURES ON A DAILY BASIS. ALL COLLECTED SEDIMENT WITHIN SEDIMENT BARRIERS SHALL BE REMOVED PERIODICALLY AS REQUIRED TO MAINTAIN THE FUNCTION OF THE SEDIMENT BARRIERS. ALL SEDIMENT COLLECTED SHALL BE RESPADE ON-SITE WITHIN STABILIZED AREAS AS DIRECTED BY THE OWNERS REPRESENTATIVE.
 - THE CONTRACTOR SHALL INSPECT DOWNSTREAM CONDITIONS FOR EVIDENCE OF SEDIMENTATION ON A WEEKLY BASIS, AFTER EACH RAINSTORM, AND AS MAY BE REQUIRED OR DIRECTED BY ALL APPLICABLE APPROVALS AND PERMITS. THE CONTRACTOR SHALL IMMEDIATELY PROVIDE A WRITTEN REPORT ON FINDINGS OF SEDIMENT IN DOWNSTREAM AREAS TO ALL AUTHORITIES HAVING JURISDICTION AND MAKE REPAIRS AS REQUIRED OR DIRECTED.
 - ADDITIONAL EROSION AND SEDIMENT CONTROL MEASURES SHALL BE INSTALLED BY THE CONTRACTOR AS REQUIRED/WARRANTED BY FIELD CONDITIONS AND AS DIRECTED BY THE OWNERS REPRESENTATIVE, JMC, AND/OR ANY AUTHORITY HAVING JURISDICTION.
 - STOCKPILING OF CONSTRUCTION MATERIAL SHALL BE PLACED ON-SITE IN THE AREA DESIGNATED ON THIS PLAN OR AS APPROVED BY THE OWNERS REPRESENTATIVE. STOCKPILED EXCAVATED MATERIAL SHALL HAVE TWO ROWS OF SILT FENCE LOCATED AROUND ITS PERIMETER. ALL STOCKPILED MATERIAL SHALL BE MAINTAINED IN AN ORDERLY MANNER SO AS NOT TO IMPEDE ON PEDESTRIAN AND/OR VEHICULAR TRAFFIC CIRCULATION ROUTES.
 - DUST SHALL BE CONTROLLED BY SPRINKLING OR OTHER APPROVED METHODS AS NECESSARY, OR AS DIRECTED BY THE OWNERS REPRESENTATIVE.
 - ALL STORMWATER MANAGEMENT PRACTICES SHALL REMAIN UNDISTURBED AND BE PROTECTED FROM HEAVY MACHINERY TRAFFIC DURING CONSTRUCTION. HOWEVER DURING CONSTRUCTION OF THE PRACTICE THE CONTRACTOR SHALL MINIMIZE AND AVOID HEAVY MACHINERY TRAFFIC TO THE MAXIMUM EXTENT PRACTICABLE. THERE SHALL BE NO STORAGE OF MATERIALS WITHIN AREAS TO BE USED FOR STORMWATER MANAGEMENT PRACTICES. THE CONTRACTOR SHALL INSTALL CONSTRUCTION FENCE AROUND THE PRACTICE TO DISCOURAGE VEHICLE TRAFFIC.
 - ALL EXPOSED SLOPES AND GRADED/DISTURBED AREAS, THAT WILL NOT BE FURTHER DISTURBED WITHIN 14 CALENDAR DAYS (7 DAYS FOR CONSTRUCTION SITES THAT EITHER DIRECTLY DISCHARGE TO ONE OF THE 303(d) SEGMENTS LISTED IN APPENDIX E OF THE GENERAL PERMIT OR ARE LOCATED WITHIN ONE OF THE WATERSHEDS LISTED IN APPENDIX C OF THE GENERAL PERMIT), SHALL BE TEMPORARILY SEEDED WITHIN 24 HOURS OF DISTURBANCE, IN ACCORDANCE WITH THE NEW YORK STATE DEPARTMENT OF ENVIRONMENTAL CONSERVATION (NYSDEC) "EROSION AND SEDIMENT CONTROL GUIDELINES" AND THE ANSI A300 "BEST MANAGEMENT PRACTICES FOR TREE AND SHRUB PLANTING, TRANSPLANTING, MAINTENANCE AND CARE," PREPARED BY THE INTERNATIONAL SOCIETY OF ARBORICULTURE (ISA), LATEST EDITIONS, AS FOLLOWS:
 - SEED MIXTURE AND RATE OF APPLICATION:
 - IN SPRING, SUMMER OR EARLY FALL, SEED THE AREA WITH RYEGRASS (ANNUAL OR PERENNIAL) AT 30 POUNDS PER ACRES (APPROXIMATELY 0.7 POUNDS/1000 SQUARE FEET OR USE 1 POUND/1000 SQUARE FEET).
 - IN LATE FALL OR EARLY WINTER, SEED THE AREA WITH CERTIFIED "AROSTOOK" WINTER RYE (CEREAL RYE) AT 100 POUNDS PER ACRE (2.5 POUNDS/1000 SQUARE FEET).
 - APPLICATION SHALL BE UNIFORM BY MECHANICAL OR HYDROSEED METHODS.
 - MULCH ALL SEEDED AREAS WITH STRAW AT A RATE OF 2 TONS PER ACRE (90 POUNDS PER 1,000 SQUARE FEET) SUCH THAT THE MULCH FORMS A CONTINUOUS BLANKET.
 - ALL SEEDED AREAS SHALL BE FERTILIZED, RESEEDED, AND MULCHED AS NECESSARY TO MAINTAIN VIGOROUS, DENSE VEGETATIVE COVER.
 - TEMPORARY SEED MIXTURES SHALL NOT BE PLACED ON AREAS WHERE FINAL GRADE HAS BEEN ESTABLISHED AND TOPSOIL HAS BEEN PLACED UNLESS OTHERWISE DIRECTED BY THE PROJECT LANDSCAPE ARCHITECT.

SEQUENCE OF CONSTRUCTION

CONSTRUCTION SHALL BE SEQUENCED IN SUCH A MANNER THAT ANY AREA WHICH IS DISTURBED SHALL FIRST BE PROTECTED WITH SEDIMENT EROSION CONTROLS AS INDICATED ON THIS PLAN. PARTICULAR REQUIREMENTS ARE GIVEN AS FOLLOWS:

- INSTALLATION OF SEDIMENT AND EROSION CONTROL MEASURES AS INDICATED ON THIS PLAN.
- DEMOLITION OF EXISTING BUILDING AS REQUIRED.
- CLEAR UNDEVELOPED PORTION OF PROPERTY WHICH IS TO BE DEVELOPED.
- STRIP AND STOCKPILE TOPSOIL.
- BEGIN BUILDING AND PARKING LOT CONSTRUCTION, ROUGH GRADING.
- INSTALL STORM DRAIN SYSTEM COMPLETE (IMMEDIATELY INSTALL INLET PROTECTION ON ALL INLETS).
- INSTALL PUBLIC UTILITIES (GAS, ELECTRIC AND TELEPHONE) AS REQUIRED.
- INSTALL CONCRETE AND ASPHALT CONCRETE PAVEMENT COMPLETE.
- FINISH GRADING, REDISTRIBUTE TOPSOIL AND ESTABLISH VEGETATION AND/OR LANDSCAPING.
- CLEAN PAVEMENTS AND STORM DRAIN SYSTEM OF ALL ACCUMULATED SEDIMENT IN CONJUNCTION WITH THE REMOVAL OF ALL TEMPORARY SEDIMENT AND EROSION CONTROL DEVICES.
- COMPLETE SITE AND BUILDING CONSTRUCTION.

ANY ALTERATION OF PLANS, SPECIFICATIONS, PLATS AND REPORTS BEARING THE SEAL OF A LICENSED PROFESSIONAL ENGINEER OR LICENSED LAND SURVEYOR IS A VIOLATION OF SECTION 7209 OF THE NEW YORK STATE EDUCATION LAW, EXCEPT AS PROVIDED FOR BY SECTION 7209, SUBSECTION 2.

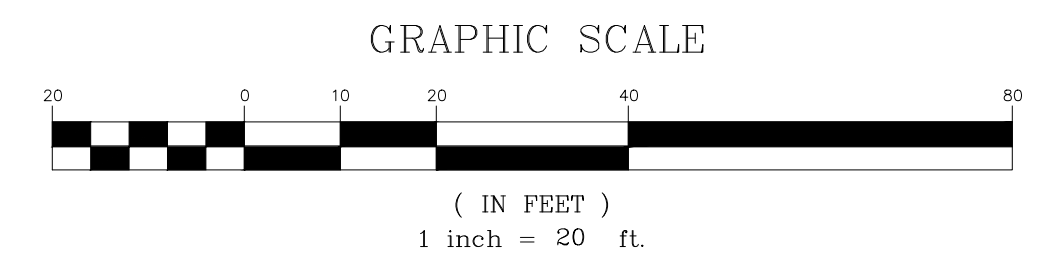

No.	Revision	Date	By
1.	REVISED PER CITY COMMENTS	12/30/19	AH

APPLICANT/OWNER:
FARRELL BUILDING COMPANY
2317 MONTAUK HIGHWAY
BRIDGEHAMPTON, NY 11932

ARCHITECT:
ARYEH SIEGEL ARCHITECT
84 MASON CIRCLE
BEACON, NY 12508

JMC Planning, Engineering, Landscape Architecture & Land Surveying, PLLC
JMC Site Development Consultants, LLC
Join Meyer Consulting, Inc.

120 BEDFORD ROAD - ARMONK, NY 10504
voice 914.273.5325 - fax 914.273.2102
www.jmcplic.com

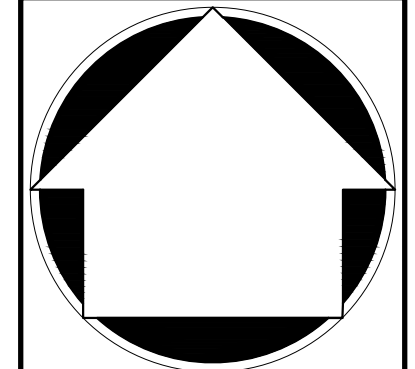
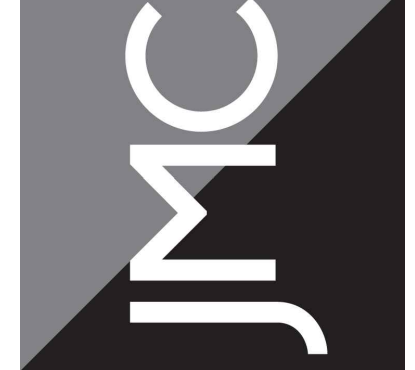

SEDIMENT AND EROSION CONTROL PLAN

BEACON COMMONS
16 WEST MAIN STREET
BEACON, NY 12508

Drawn: AH Approved: SS
Scale: 1" = 20'
Date: 10/29/2019
Project No: 18119
1819-DT S&E S&E.scr
Drawing No: **C-400**
(Sheet 7 of 24)
Previous Editions Obsolete